



Register your new Bosch now:
www.bosch-home.com/welcome



Tumble dryer
WTH83007SN



BOSCH

en Installation and operating instructions

Your new tumble dryer

You have opted for a tumble dryer manufactured by Bosch.

Please take a few minutes to read and become familiar with the advantages of your tumble dryer.

To meet the high quality demands required by Bosch, every tumble dryer that leaves our factory is carefully checked to ensure that it functions correctly and is in perfect condition.

For more information on our products, accessories, replacement parts and services, see our website www.bosch-home.com or contact our Customer Service centres.

If the operating and installation instructions describe different models, any differences will be pointed out at the relevant points in the text.



Read these operating and installation instructions before operating the tumble dryer.

Display rules

Warning!

This combination of symbol and signal word indicates a possibly dangerous situation. Not heeding the warning can cause death or injuries.

Caution!

This signal word indicates a possibly dangerous situation. Not heeding the caution can cause property and/or environmental damage.

Note/tip

Information about the optimum use of the appliance/any other useful information.













1. 2. 3. / a) b) c)

The steps are represented by numbers or letters.

■ / -

Lists are represented by a small box or a dash.

Contents

	Intended use	4		Signal setting	20
	Safety instructions	4		Noises	21
	Electrical safety	4		Cleaning	21
	Safety for children	5		Cleaning the dryer and the control panel	21
	Appliance safety	5		Cleaning the moisture sensor	21
	Environmental protection	7		Cleaning the EasyClean filter	22
	Packaging/old appliance	7		Faults and what to do about them	23
	Coolant	7		Consumption values	25
	Energy-saving tips	7		Consumption values table	25
	The main points in brief	8		Most efficient programme for cotton fabrics	25
	Getting to know your appliance .9			Technical data	26
	Dryer	9		After-sales service	27
	Control panel	10		Installation and connection . . .28	
	Display panel	11		Scope of delivery	28
	Laundry	12		Installing and connecting the dryer . .28	
	Preparing the laundry	12		Optional accessories	29
	Sorting washing according to:	12		Transport and frost protection	29
	Programmes and buttons	13			
	Programmes	13			
	Buttons	15			
	Operating the appliance	16			
	Loading laundry and switching on the dryer	16			
	Setting a programme	16			
	Starting the programme	16			
	Programme sequence	16			
	Changing the programme or adding laundry	17			
	Cancelling the programme	17			
	Programme end	17			
	Removing laundry and switching off the dryer	17			
	Emptying the condensate container . .18				
	Clean the fluff filter	19			



Intended use

- For private domestic use only.
- Only to dry and refresh fabrics that have a care label specifying that they are suitable for use in a dryer.
- The dryer can be operated by children 8 years old and older, by persons with reduced physical, sensory or mental abilities and by persons with insufficient experience or knowledge if they **are supervised** or have **been instructed** in its use by a responsible adult.
- Keep children under the age of 3 years old away from the dryer.
- This appliance is intended for use up to a maximum height of 4000 metres above sea level.
- Do not let children carry out any unsupervised cleaning or maintenance work on the dryer.
- Keep pets away from the dryer.



Safety instructions

Electrical safety



Warning

Risk of death!

There is a risk of electric shock as the dryer is operated with electricity.

You should therefore observe the following:

- Never touch or hold the mains plug with wet hands.
- Only pull out the mains cable directly at the plug and never by the cable, as this could damage it.
- Do not use extension cables, multiple plugs or connectors.
- Only have the mains cable replaced by our after-sales service.

Safety for children

Warning

Risk of death or injury!

You should therefore observe the following:

- Do not leave the dryer unattended when children or other people who cannot assess the risks are nearby.
- Do not let children play with the dryer.
- Children may become entangled in packaging or film if allowed to play with them, or they may pull them over their heads and suffocate. Keep packaging, packaging parts and film out of the reach of children.
- Children may lock themselves in the dryer. Therefore, when an appliance has reached the end of its service life, unplug it from the mains, cut through the mains cable and destroy the lock on the dryer door.

Appliance safety

Warning

Risk of death!

- Do not use the dryer if industrial chemicals have been used to clean it.
- Laundry that has come into contact with solvents, oil, wax, wax remover, paint, grease or stain remover may ignite or cause an explosion when drying is in progress. Before drying, rinse the laundry in hot water with detergent.
- Coal dust or flour in the area around the dryer may cause an explosion.
- Only replace defective components with genuine spare parts.

Caution!

Risk of material damage to the dryer or fabrics

- Only use the dryer for drying and freshening up fabrics at home and for fabrics that have been washed with water and are suitable for tumble-drying. Any other use is not considered intended use and is prohibited.
- Foamed material or foam rubber may become deformed or melt during drying. Do not dry any laundry that contains foamed material or rubber.
- Do not lean or sit on the dryer door, as the dryer may tip over.
- Loose cables or hoses may cause you to trip. Avoid tripping hazards.
- Light things, such as hair, may be sucked into the air inlet during operation; keep these away from the dryer.
- The last phase of the drying cycle takes place without any heat (cooling cycle) to ensure that the laundry remains at a temperature that will not damage it.



Environmental protection

Packaging/old appliance



Dispose of packaging in an environmentally-responsible manner.

This appliance is designated according to European directive 2012/19/EC which governs waste electrical and electronic equipment (WEEE).

The directive provides a framework for the collection and recycling of old appliances, which is valid across the EU.

Coolant

The dryer's heat exchanger contains fluorinated greenhouse gas in a hermetically sealed unit.

Greenhouse gas:	R134a
Capacity (g):	215
GWP (kgCO₂/kgRefrig):	1300
Total GWP (kgCO₂):	280

Dispose of the dryer properly.

Energy-saving tips

- Spin the laundry before drying. The drier the laundry, the shorter the drying time will be, thus consuming less energy.
- Load the dryer with the maximum load.
 - Note:** Do not exceed the maximum load for the programs, as this prolongs the drying time and increases energy consumption.
- Ventilate the room and keep the air inlet on the dryer free to ensure air exchange.
- Clean the fluff filter after each drying cycle. If the fluff filter is dirty, the drying time is prolonged and energy consumption is increased.
- **Energy saving mode:** If the dryer is not operated for a prolonged period, it automatically switches off before the program starts and when the program has ended to save energy. The display panel and indicator lamps go off after a few minutes and the Start button flashes. To activate the lighting, press any button, open or close the dryer door or turn the program selector.



The main points in brief

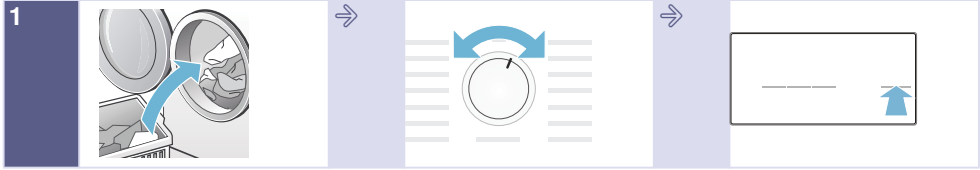

1 Load the laundry and close the door.

Switch the dryer on by turning the programme selector to the required programme.

Press the Start button.

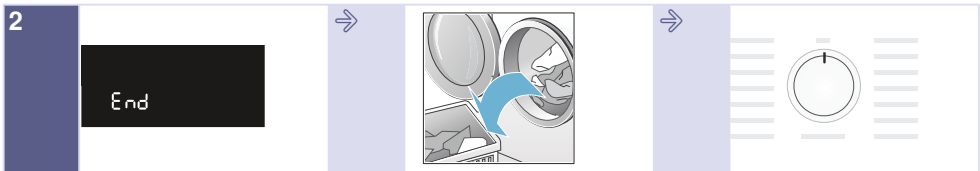

2 End of the programme.

Remove the laundry.

Switch the dryer off.

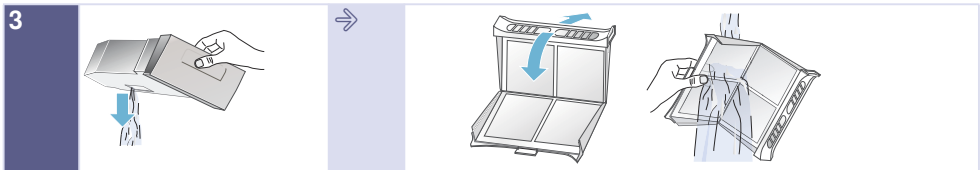

3 Empty the condensation container.

Clean the fluff filter.

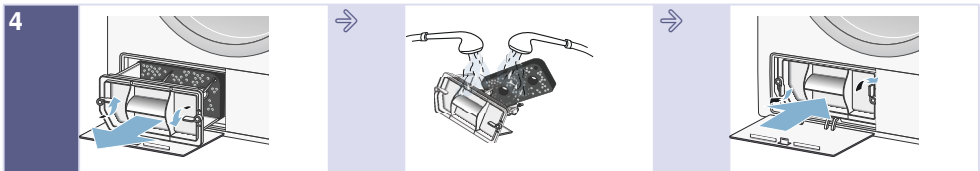

4 When  appears in the display panel, remove the EasyClean filter.

Clean and dry the EasyClean filter.

Re-insert the EasyClean filter.

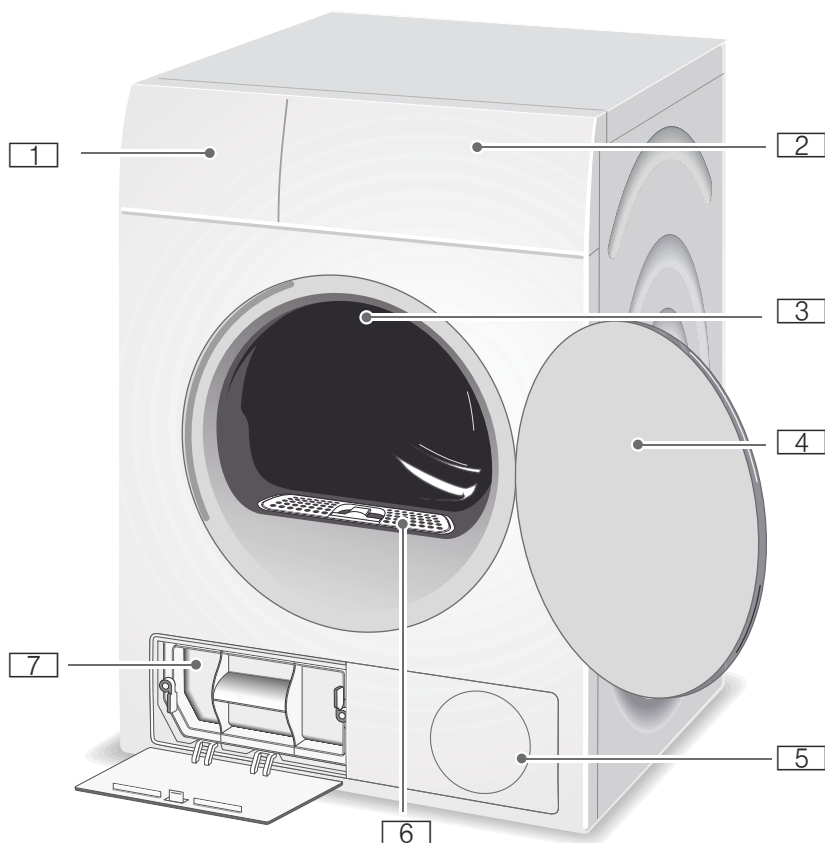
 **Getting to know your appliance****Dryer**

- 1 Condensate container
- 2 Control and display panel
- 3 Drum interior light*
- 4 Dryer door
- 5 Air inlet
- 6 Fluff filter
- 7 EasyClean filter

* depending on the model

Control panel

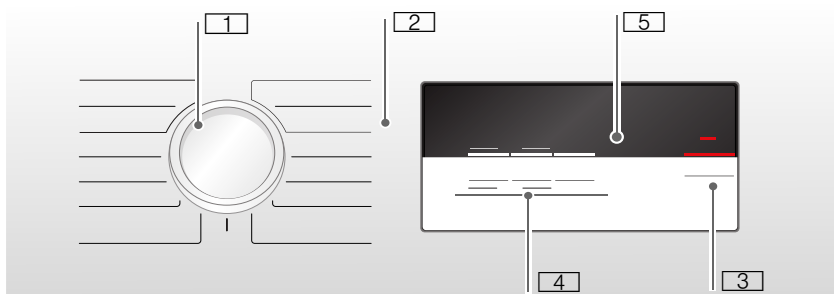

- 1** **Programme selector** for switching the dryer on/off and selecting the programme.
- 2** **Programmes** → *Page 13*.
- 3** **Start button** for starting or interrupting the programme → *Page 15*.
- 4** **Buttons** for applying default programme settings → *Page 15*.
- 5** **Display panel** → *Page 11*.

Display panel

Buttons on the display panel

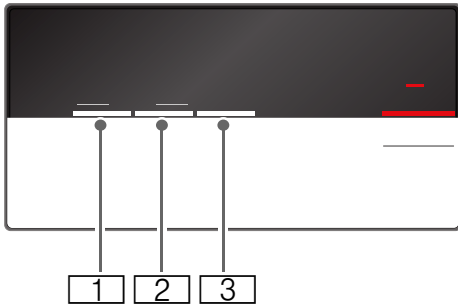

1 **Drying level.**





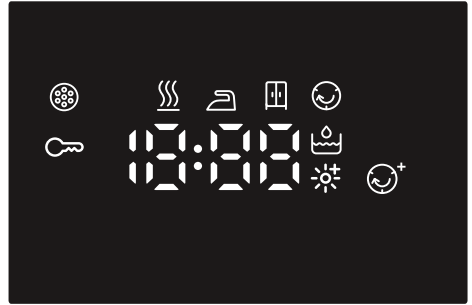

2 **Ready in.**

3 **Anti-crease.**

For a detailed description of all buttons, see → *Page 15* onwards.

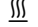
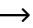
Display panel



-  Empty the condensate container
→ *Page 18*.
-  Clean the EasyClean filter
→ *Page 22*.
-    - **P** - **End**: Programme progress for Dry, Iron Dry, Cupboard Dry, Anti-crease, Pause and End of programme.
-  Childproof lock active
→ *Page 15*.
-  Anti-Crease selected.
-  Drying level selected.
- 1:27** Expected programme duration in hours and minutes.
- 3 h** Programme will end in 3 h/hours with the "Ready in" time selected.



Laundry

Preparing the laundry



Warning

Risk of explosion or fire!

Remove any cigarette lighters and matches from pockets.

Caution!

The dryer drum and fabrics may be damaged.

Remove all objects from pockets and take note of the following information:

- Tie cloth belts, apron strings, etc. together or use a laundry bag.
- Close zips, hooks and eyes, and do up any buttons.
- To ensure a consistent drying result, sort the laundry by fabric type and drying programme.
- Remove any metal objects, such as paper clips, from pockets.
- Knitted fabrics, such as T-shirts and jerseys, often shrink slightly the first time they are tumble-dried. Use a gentle programme.
- Do not over-dry easy-care laundry. This increases creasing of the laundry.
- When washing laundry that is to be tumble-dried afterwards, use the correct amount of fabric softener as specified in the manufacturer's instructions.

Sorting washing according to:

- Suitable for tumble drying
- Dry at normal temperature
- Dry at low temperature
- Do not tumble-dry

If you dry thin- and thick-layered fabrics and fabrics with several layers together, these will dry to differing degrees.

To achieve an even drying result, you should therefore only dry laundry of the same type of fabric and structure together. If you feel that the laundry is still too damp afterwards, you can select a time programme for subsequent drying → *Page 13*.















Caution!





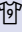

Risk of material damage to the dryer or laundry.

Do not dry non-breathable fabrics, such as rubber-coated laundry.





Programmes and buttons

Programmes

Programme and fabrics	Maximum load and programme settings/info
Name of the programme Which fabrics is the programme suitable for?	The maximum load is based on the dry weight of the fabrics Possible programme settings
Cottons  Cupboard Very Dry 	7 kg
Hard-wearing, heat-resistant fabrics that are made of more than one layer of cotton or linen and do not dry readily.	
Cottons  Cupboard Dry 	7 kg
Normal, hard-wearing and heat-resistant fabrics made of a single layer of cotton or linen.	
Cottons  Iron Dry 	7 kg
Normal, hard-wearing and heat-resistant fabrics made of a single layer of cotton or linen that need to be damp after drying and are suitable for ironing or hanging up.	
Easy-Care  Cupboard Very Dry 	3.5 kg
Synthetic or blended fabrics that are made of more than one layer and do not dry readily.	
Easy-Care  Cupboard Dry 	3.5 kg
Normal synthetic or blended fabrics made of a single layer.	
Easy-Care  Iron Dry 	3.5 kg
Normal synthetic or blended fabrics made of a single layer that need to be damp after drying and are suitable for ironing or hanging up.	
Sport 	1.5 kg
Weatherproof and outdoor clothing with a membrane coating and water-repellent fabrics.	
Towels 	6 kg
Hard-wearing towels made of cotton.	
Mix 	3 kg
Mixed load consisting of cotton and synthetic fabrics.	

<p>Time program warm 30' </p> <p>All types of fabric; time programme</p> <p>Suitable for pre-dried or slightly damp laundry and for drying off multi-layered, thick laundry.</p> <p>Notes</p> <ul style="list-style-type: none"> ■ Only dry wool, sports shoes and soft toys with the basket for woollens → <i>Page 29</i>. ■ In the time programme, the laundry's residual moisture is not automatically detected. If the laundry is still too damp after the drying programme, repeat the programme. 	3 kg
<p>Time program cold 30' </p> <p>Time programme for all types of fabric except for wool and silk.</p> <p>All types of fabric. For freshening up or airing items of laundry that have not been worn frequently.</p>	3 kg
<p>Shirts </p> <p>Non-iron shirts or blouses made of cotton, linen, synthetic fibres or blended fabrics.</p>	1.5 kg
<p>Super Quick 40' </p> <p>Synthetics and light cottons.</p>	1 kg
<p>Wool finish </p> <p>Fabrics made from wool or a wool blend that are suitable for tumble drying.</p>	3 kg
<p>Delicates </p> <p>For delicate, washable underwear, e.g. made of velvet, lace, Lycra, silk or satin.</p>	1 kg

Buttons

Buttons	Explanations and notes
Note: Not all buttons and their functions can be selected in all programmes.	
 (Drying level)	If your laundry is too damp after drying, you can adjust the drying settings, e.g. Cup-board Dry, using the drying level button. The drying setting can be increased in three stages from 1 to 3 using the drying level button. Once you have adjusted the drying level, this setting will be retained even after the dryer has been switched off.
 (Ready in)	The programme will end in 1-24 hrs. Set the "Ready in" time in increments of one hour to delay the start of the programme. The required number of hours after the programme ends is displayed in the display panel.
 3 sec. (childlock)	Activate or deactivate the childproof lock by pressing and holding the drying level button and the "Ready-in" time button at the same time for three seconds.
 (Less ironing)	The drum moves the laundry at regular intervals after drying to prevent creasing. You can extend the automatic Anti-Crease function by 60 minutes after any programme has finished.
 (Start/Pause)	Starts or pauses the programme.



Operating the appliance

Loading laundry and switching on the dryer

Note: The dryer must be correctly positioned and connected, → *Page 28*.

1. Place the laundry in the drum.
2. Turn the programme selector to any programme to switch the dryer on.
3. Close the dryer door.

Caution!

Possibility of material damage to the dryer or laundry.

Take care not to trap any laundry in the door.

Setting a programme

Note: If you have activated the childproof lock, you must deactivate it before you can set a programme, see → *Page 15*.

1. Select the required programme; detailed information on the programmes can be found on → *Page 13* onwards.

2. Use the programme selector to set the required programme. The default programme settings for the selected programme appear in the display panel.

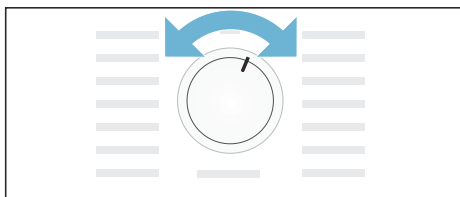

Note: Default programme settings are standard settings that are already defined when a programme is selected. After selecting a programme, you can see the default programme settings in the display panel.

3. If required, adjust the default programme settings. You can find detailed information on this on → *Page 15* onwards.

Starting the programme

Press the Start button.

Note: If you want to lock the programme to prevent it from being inadvertently adjusted, you can select the childproof lock, see → *Page 15*.

Programme sequence

The programme status is displayed in the display field.

Changing the programme or adding laundry

You can remove or add laundry and change or alter the programme at any time during drying.

1. To pause the programme, open the dryer door or press the Start button.
2. Add or remove laundry.
3. Select another programme or an additional function, if required.
4. Close the dryer door.
5. Press the Start button.

Note: The programme duration in the display panel is updated depending on the load and residual moisture in the laundry. The values displayed may change after the programme is changed or the load is adapted.

Cancelling the programme

The programme can be interrupted at any time; to pause, open the dryer door or press the Start button.

Caution!

Risk of fire. Laundry may catch fire.

If you cancel the programme, you must remove the laundry items and spread them out so that the heat can disperse.

Programme end

End appears in the display panel.

Removing laundry and switching off the dryer

1. Remove the laundry.
2. Turn the programme selector to the "off" position.

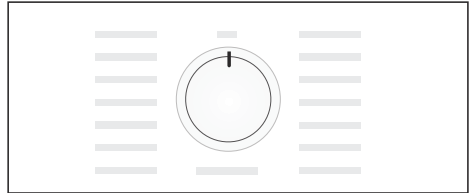

Emptying the condensate container

Notes

- You can drain off the condensation into the waste-water system using an optional condensation drain*.
- If you drain the condensation using an optional condensation drain, you do not have to empty the condensate container.

Note: After each drying cycle, empty the condensate container; otherwise the next drying programme may be cancelled as a result of the condensate container being full.

1. Pull out the condensate container horizontally.

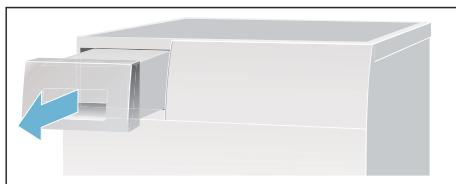

2. Pour out the condensation water.

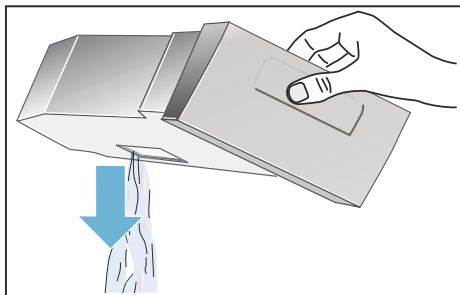

Caution!

Dirty condensation water may be harmful to your health and cause material damage.

Condensation water is not suitable for drinking and may be contaminated with fluff. Do not drink the condensation water or reuse it.

3. Push in the condensate container until you feel it lock back into place in the dryer.

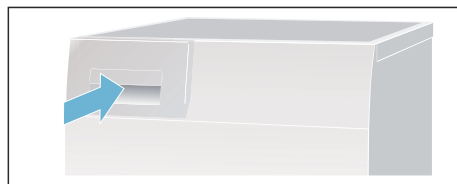

* Depending on the model

Clean the fluff filter

Note: During drying, fluff and hair from the laundry is trapped by the fluff filter. If the fluff filter is blocked or dirty, this reduces the flow of air, which prevents the dryer from achieving its maximum performance. Clean fluff filters also reduce energy consumption and the drying time.

Clean the fluff filter **after each** drying cycle:

1. Open the dryer door and remove all fluff from the door.
2. Pull out the two-part fluff filter.

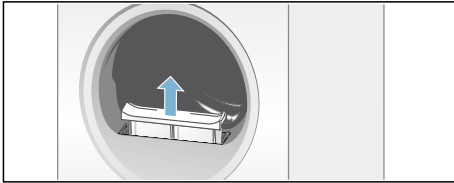

3. Remove the fluff from the recess in the fluff filter.

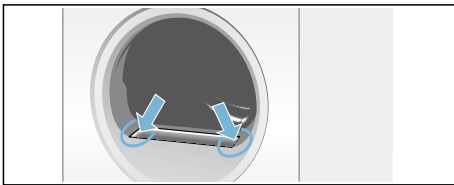

Note: Ensure that no fluff falls into the open shaft.

4. Pull apart the two-part fluff filter.

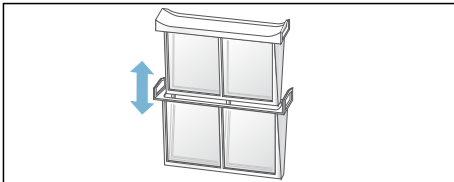

5. Open both filters and remove all the fluff.

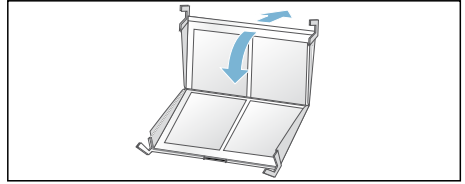

6. Rinse away the fluff under warm, running water.

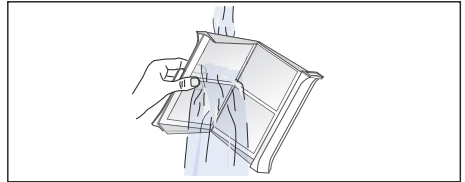

7. Dry the fluff filter, close it and reinsert the two-part fluff filter.

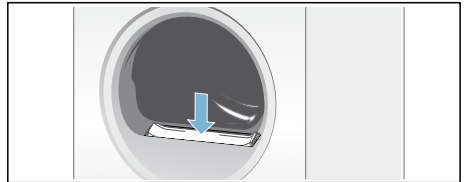

Caution!
The dryer may be damaged.

Do not operate the dryer without a fluff filter or if the fluff filter is defective.

Signal setting

You can change the following settings:

- The spin speed that is used for spinning your laundry before it is dried,
- The volume of the audible signal at the end of the programme,
- The volume of the audible button signals.

You will need to activate the setting mode in order to change these settings.

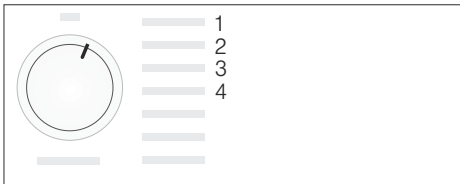

Activating setting mode

1. Switch the dryer on.
2. Select the "Cottons" programme in position 1 and wait for 5 seconds.

Setting mode is now activated. The symbols go out on the display panel and the programme duration is displayed.

1. Press and hold the Start button and, at the same time, turn the programme selector clockwise to position 2.
2. The **spin speed** is shown on the display.
3. Press the "Ready in" time button to change the spin speed.
4. Turn the programme selector clockwise to position 3.

5. The volume for the **audible signal at the end of the programme** is shown on the display.



0 = off, 1 = quiet, 2 = medium, 3 = loud, 4 = very loud

6. Press the "Ready in" time button to change the volume.
7. Turn the programme selector clockwise to position 4.
8. The volume for the **audible button signal** is shown on the display.



0 = off, 1 = quiet, 2 = medium, 3 = loud, 4 = very loud

9. Press the "Ready in" time button to change the volume.

Note: You can select other positions with the programme selector; however, you will be unable to change these settings.

Exiting setting mode

Turn the programme selector to the "Off" position once you have set the required spin speed and the volume. The settings have now been saved.

Noises

Note: During drying, particularly in the initial phase, operation of the appliance results in noise from the compressor and pump. This is perfectly normal and does not impair proper functioning of the appliance.

From time to time, the compressor in the dryer generates a humming noise. However, the volume may vary depending on the programme and progress of the drying process.

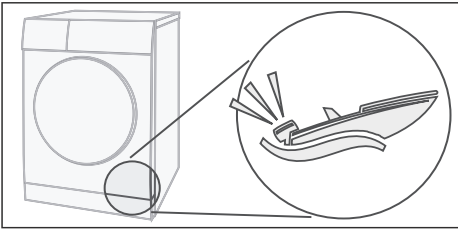

Every now and then, the compressor is ventilated. This creates a whirring noise.

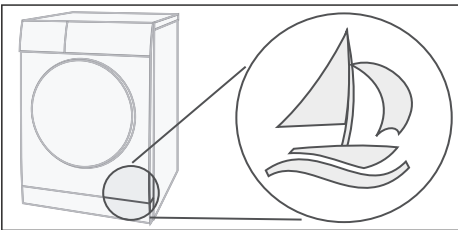

The condensation is pumped into the condensation container by a pump. This generates pumping noises.

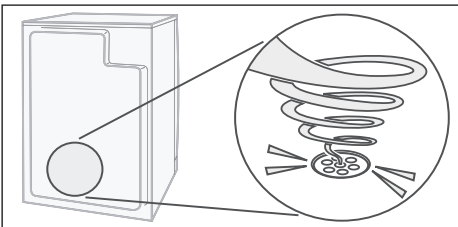

Cleaning

Cleaning the dryer and the control panel

Warning **Risk of death!**

There is a risk of electric shock as the dryer is operated with electricity. Disconnect the dryer from the mains before cleaning.

Clean the dryer using only water and a soft, damp cloth.

Remove all detergent residue, spray residue or other residues immediately. Do not use cleaning agents or agents for pre-treating laundry (e.g. prewash sprays, stain removers). Do not use high-pressure cleaners or steam jet cleaners to clean your appliance.

Cleaning the moisture sensor

Note: The dryer is equipped with a stainless-steel moisture sensor. The moisture sensor measures how damp the laundry is. After long periods of use, a fine layer of limescale can form on the moisture sensors. This must be removed regularly.



Open the door and clean the moisture sensor with a rough sponge.

Caution! **The moisture sensor may be damaged.**

Do not clean the moisture sensor with steel wool and abrasive materials.

Cleaning the EasyClean filter

When  appears in the display panel, clean the EasyClean filter as follows:

The appliance must be switched on.

1. First clean the fluff filter → Page 19.
2. Close the door of the dryer.
3. Open the maintenance flap on the heat exchanger.
4. Release the levers on the EasyClean filter.
5. Use the grip handle to pull the EasyClean filter out.

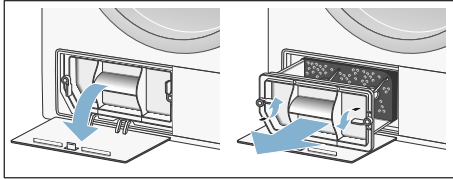

6. Now take off the filter mat.
7. Wash out the filter mat by hand using clean water.

Notes

- If the filter mat is covered with stubborn dirt, you can also remove this carefully using a vacuum cleaner.
- Do not use cleaning agents.

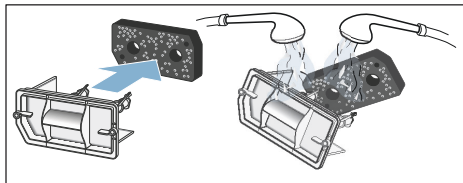

8. Dry the filter mat by squeezing the water out.

Note: Only use the filter mat if it is clean and dry.

9. Put the filter mat back on.

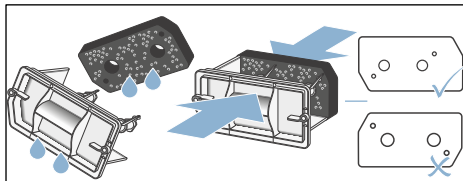

Note: Ensure that the filter mat is not misshapen, torn or clogged. Position the filter mat as shown above.

10. Check how dirty the dryer's heat exchanger is before putting the EasyClean filter back in. If it is very dirty, use a vacuum cleaner with a brush attachment to clean it carefully from top to bottom.

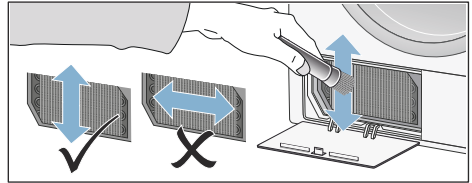

Note: Take care not to bend or damage the fins on the heat exchanger when cleaning it.

Caution!

Risk of injury.

You could cut yourself on the fins of the heat exchanger.

Do not touch these with your hands.

11. Slide the EasyClean filter in and make sure it clicks into place.
12. Close the maintenance flap.

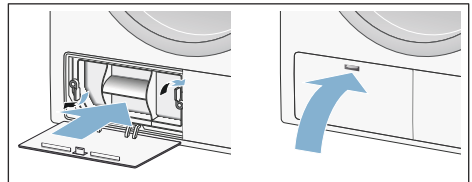

13. Switch the dryer off.



You have now cleaned the EasyClean filter.

Note: If your filter mat is damaged, you can order a new one from the after-sales service using part number: 12007650.

Contact information for all countries can be found on the enclosed after-sales service list.



Faults and what to do about them

Faults	Cause/remedy
 on the display panel and drying has been interrupted.	<ul style="list-style-type: none"> ■ Empty the condensation container and press the Start button. ■ If the optional condensation drain has been installed, the drain hose may be blocked or kinked. Check the hose for deposits and flush the hose out. Make sure that the hose does not have any kinks when it is in place.
 on the display panel.	Clean the fluff filter → <i>Page 19</i> and the EasyClean filter → <i>Page 22</i> .
 on the display panel even though the fluff filter and the EasyClean filter have been cleaned.	It is important to proceed in the order set out in the section entitled → <i>Page 22</i> . Note: The appliance must be switched on when it is cleaned.
Dryer will not start.	<ul style="list-style-type: none"> ■ Start button selected? ■ Mains plug plugged in or fuse checked? ■ Programme selected? Select a programme. ■ Dryer door open? Close the door. ■ Is the childproof lock activated? Deactivate the childproof lock. ■ "Ready in" time selected? Programme starts after a delay.
Creasing.	<ul style="list-style-type: none"> ■ Creasing occurs when you have exceeded the maximum permitted load or selected the wrong programme for the type of fabric. All the required information can be found in the programme table. ■ Remove clothes immediately after drying; creasing may occur if they are left in the drum.
Water is leaking out.	Not a fault; the dryer may be positioned on an incline. Level the dryer.
Laundry is not dried properly or is still too damp.	<ul style="list-style-type: none"> ■ After the programme has ended, warm laundry feels damper than it actually is. Spread the laundry out and allow the heat to disperse. ■ Finely adjust the dryness level – this extends the drying time but does not increase the temperature. Your laundry will become drier → <i>Page 15</i>. ■ Select a programme with a longer drying time or increase the dryness level. This does not increase the temperature. ■ Select a timed programme to add extra drying time for laundry that is still damp → <i>Page 13</i>. ■ If you have exceeded the maximum permitted load for the programme, the laundry may not be dried properly. ■ Clean the moisture sensor in the drum. A fine layer of limescale may adversely affect the performance of the sensors and your washing will not dry properly → <i>Page 21</i>. ■ Drying has been interrupted as a result of a power cut, because the condensation container is full or because the maximum permitted drying time has been exceeded. <p>Note: See also the laundry tips → <i>Page 12</i>.</p>

* Depending on the model

Faults	Cause/remedy
Drying time too long?	<ul style="list-style-type: none">■ The fluff filter or the EasyClean filter may be dirty, which will make the drying time longer. Clean the fluff filter or the EasyClean filter.■ If the air inlet on the dryer is blocked or not freely accessible, this may increase the drying time. Make sure that the air inlet remains unobstructed.■ If the ambient temperature is higher than 35 °C, this may extend the drying time.■ Insufficient air circulation in the room may increase the drying time. Ventilate the room.
Display panel goes off and Start button flashes.	Not a fault. Energy-saving mode is active → <i>Page 7</i> .
Humidity in the room increases.	Not a fault. Make sure the room is sufficiently ventilated.
Power cut.	The drying programme is interrupted. Remove the laundry and spread it out, or restart the programme.
Unusual noises when drying.	Not a fault; see also → <i>Page 21</i> .
The dryer feels cold despite drying.	Not a fault. The dryer can dry efficiently at low temperatures using a heat pump.
* Depending on the model	

Note: If you cannot rectify the fault yourself by turning the dryer off and then on again, please contact our after-sales service.



Consumption values

Consumption values table

Programme	Spin speed used for spinning the laundry	Duration**		Energy consumption**	
		7 kg	3.5 kg	7 kg	3.5 kg
Cottons					
Cupboard Dry*	1400 rpm	173 min	100 min	1.81 kWh	1.00 kWh
	1000 rpm	196 min	119 min	1.91 kWh	1.09 kWh
	800 rpm	219 min	142 min	2.15 kWh	1.30 kWh
Iron Dry*	1400 rpm	136 min	75 min	1.10 kWh	0.66 kWh
	1000 rpm	159 min	89 min	1.45 kWh	0.88 kWh
	800 rpm	182 min	102 min	1.73 kWh	1.04 kWh
Easy-Care		3.5 kg		3.5 kg	
Cupboard Dry*	800 rpm	66 min		0.55 kWh	
	600 rpm	78 min		0.64 kWh	
* Programme setting for testing in accordance with the applicable EN 61121 standard.					
** The values may differ from those specified, depending on the type of fabric, composition of laundry to be dried, residual moisture in the fabric, the degree of dryness that has been set and the amount of laundry being loaded.					

Most efficient programme for cotton fabrics

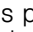
The following "standard cottons programme" (identified with ) is suitable for drying normal, wet cotton laundry and is most efficient in terms of its combined energy consumption for drying wet cotton laundry.

Standard programmes for cottons in accordance with current EU regulation 932/2012

Programme	Load	Energy consumption	Programme length
 Cottons Cupboard Dry	7 kg/3.5 kg	1.91 kWh/1.09 kWh	196 min./119 min.

Programme setting for testing and energy labelling in accordance with Directive 2010/30/EU.



Technical data

Dimensions:

85 x 60 x 60 cm

Height x width x depth

Weight:

Approx. 48 kg

Maximum load:

7 kg

Condensate container:

4.8 l

Connected voltage:

220 - 240 V

Connected load:

Max. 600 W

Fuse:

10 A

Drum interior light*

Ambient temperature:

5 - 35 °C

**Power consumption when
switched off:**

0.10 W

**Power consumption when
ready for use (left-on mode):**

0.50 W

* Depending on the model



After-sales service

After-sales service

If you cannot rectify the fault yourself (faults, what to do?), please contact our after-sales service. We will always find an appropriate solution to avoid unnecessary visits by engineers.

The contact information for your nearest after-sales service can be found here or in the enclosed after-sales service directory.

Please provide after-sales service with the dryer's product number (E-no.) and production number (FD).

E-Nr. _____ FD _____

You can find this information on the inside of the dryer door or on the rear of the dryer.

Trust the expertise of the manufacturer.

Contact us. You can therefore be sure that the repair is carried out by trained service technicians who carry original spare parts.



Installation and connection

Scope of delivery

- Dryer
- Installation and operating instructions
- Basket for woollens*
- Condensation drain*

Installing and connecting the dryer



Warning **Risk of death!**

There is a risk of electric shock as the dryer is operated with electricity.

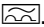
- Check the dryer for visible damage. You must not operate the dryer if it is damaged.
- Before connecting the dryer to the power supply, ensure that the electric voltage specified on the rating plate matches the voltage of your socket.
- Only use earth-leakage circuit breakers with the following symbol:

- Ensure that the mains cable is not kinked or trapped, and that it does not come into contact with heat sources or sharp edges.



Warning **Children may lock themselves in the dryer, putting their lives at risk!**

Do not set up the dryer behind a door or sliding door, as this may obstruct the dryer door or prevent it from opening.

Caution!

Risk of injury

- Due to the heavy weight of the dryer, you may injure yourself if you lift it. Do not lift the dryer on your own.
- You could cut your hands on the sharp edges of the dryer. Do not hold the dryer by the sharp edges.
- Protruding parts on the dryer may break off when it is lifted or pushed. Do not move the dryer by holding onto protruding parts.

Caution!

Risk of material damage to the dryer or fabrics.

- Check the dryer for damage caused during transportation. Never operate a dryer if it is damaged.
- Any residual water in the dryer may freeze and damage the dryer. Do not install the dryer in rooms that are at risk of frost.

During installation, ensure that:

- The dryer is placed on a clean, level and firm surface,
- The mains plug can be accessed at all times,
- The air inlet on the dryer is kept clear and there is sufficient ventilation,
- The area around the dryer is kept clean and
- The dryer is levelled using the threaded feet. Use a spirit level to do this.

* Depending on the model

Optional accessories

Order optional accessories* from the after-sales service:

- **Washer-dryer stack connection set:**
To save space, the dryer can be placed on top of a suitable washing machine of the same width and depth.
The dryer must be fastened to the washing machine using this connection set.
Order number with pull-out worktop: **WTZ11400**;
Order number without pull-out worktop: **WTZ20410**.
- **Platform:**
For easier loading and unloading, raise your dryer with a platform.
Transport laundry with the clothes basket integrated into the platform drawer.
Order number: **WMZ20500**.
- **Basket for woollens:**
Dry individual woollen items, sports shoes and soft toys in the basket for woollens.
Order number: **WMZ20600**.
- **Connecting kit for the condensation drain:**
Use a hose to draw off the condensation immediately.
Order number: **WTZ1110**.

Transport and frost protection

1. Empty the condensate container.
2. Select any programme using the programme selector.
3. Press the Start button.
4. Wait for 5 minutes.
Note: The condensation is drained.
5. Empty the condensate container again.
6. Switch off the dryer.

Note: Despite draining, there will always be some residual water in the dryer.

Caution!

Any residual water may leak out and cause material damage.

Transport the dryer in an upright position.

Caution!

The dryer contains coolant and may be damaged.

Allow the dryer to rest for two hours before initial use.

* Depending on the model



A series of horizontal lines for writing, starting with a longer line below the pencil icon and followed by many shorter, uniform lines.



Advice and repair order in the event of faults

GB 0344 892 8979 (Calls charged at local or mobile rate.)

IE 01450 2655 (0.03 € per minute at peak. Off peak 0.0088 € per minute.)

You can find the contact information for all countries in the attached after-sales service directory.

Robert Bosch Hausgeräte GmbH
Carl-Wery-Straße 34
81739 München, GERMANY



9001089336 (9507)