

# (MS-602B)使用說明書

尊貴的客户:

首先感谢您購買我們的產品,在碼表使用前請詳細閱讀本說明書以進行正確的設置和使用。

## 安裝圖示(Installation illustration)

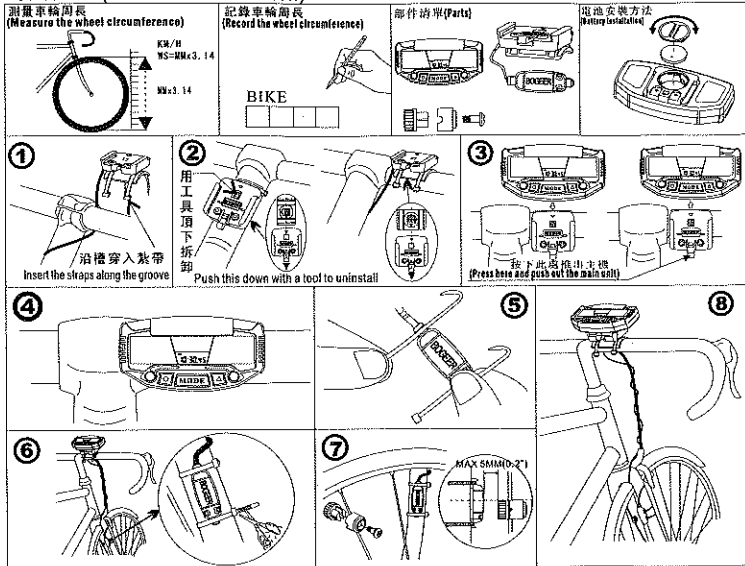

### 一、參數設置:

首先要測量出車輪的周長,得出車輪周長後在DST或ODO模式時按住碼表 **3** 秒即可進入參數設置模式,在設置模式中 **3** 鍵為確定鍵, **▲** 鍵為切換或調整鍵。  
 按 **3** 秒進入設置模式,首先要選擇溫度(Th)模式:按 **▲** 鍵切換攝氏/華氏溫度,按 **3** 鍵確定選擇並進入12/24小時時間制選擇,按 **▲** 鍵切換12/24小時制,按 **3** 鍵確定選擇,然後進入小時設定,小時數值閃爍,按 **▲** 鍵進行調整,按 **3** 鍵確定並依次進入分鐘,秒設定,按 **▲** 鍵進行調整,完成後按 **3** 鍵進入車輪周長設定,按 **▲** 鍵改變閃爍的數值,按 **3** 鍵確定並進入下一位數值設定,設定範圍0CM~999.9CM。(預設為208.0CM),完成周長設定後進入公制(Km)/英制(Mile)單位選擇,按 **▲** 鍵切換公/英制單位,按 **3** 鍵確定選擇,然後進入英里設置(ODO),按 **▲** 鍵對閃爍的數值調整,按 **3** 鍵進入下一位,按照個、十、百、千位輸入(默認為0000),確定後進入累計騎車時間(TT)進行設置,按 **▲** 鍵調整閃爍的數值,按 **3** 鍵確定並進入下一位設置,完成累計騎車時間設置後碼表就進入DST工作狀態。  
 注意:在設置狀態時,15秒內沒任何設置則進入DST模式狀態。

### 二、開機模式

碼表在4分鐘內沒有行車訊號輸入,則會自動進入開機模式,螢幕只顯示時間。當有行車訊號或者按任一鍵可恢復到開機前模式,並保留了開機前的各項資料。

### 三、功能查詢:

#### 1、模式切換

碼表默認狀態為DST模式,RAT數據欄和RT數據欄切換顯示,連續按MODE鍵,就會在DST模式,DST UP/DN模式,ODO模式之間循環顯示。

#### 2、數據的查詢

在顯示DST模式時可查詢DST(騎車里程)資料,RAT(行程時間)資料,RT(騎車時間)資料、當前時間,在待機狀態時顯示SPD AVS(平均速度),在工作狀態時顯示SPD(實時速度)。

在顯示DST UP/DN模式時可查詢騎車里程(DST)正計(UP)或倒計(DN),騎車時間(TM)正計(UP)或倒計(DN)和當前時間,SPD(實時速度)。

在顯示ODO模式時可查詢ODO(累計騎車總里程),TT(累計騎車總時間),Th(當前溫度)、SPD MXS(最高速度)。

#### 四、設置騎車正計或倒計

連續按MODE鍵切換到DST UP/DN(騎車正計或倒計)模式,按 **3** 鍵切換UP(正計)和DN(倒計)模式,確定需要的模式後,長按 **3** 秒即進入騎車里程(DST)設置,按 **▲** 鍵調整閃爍的數值,按 **3** 鍵確定並進入下一個數值設置,完成騎車里程數值設置後會自動進入騎車時間(TM)設置,同樣是按 **▲** 鍵調整閃爍的數值,按 **3** 鍵確定並進入下一個數值,設置完騎車時間後碼表會進入DST UP/DN模式工作狀態。

#### 五、秒錶使用

在DST和ODO模式時按 **3** 鍵即可啟動秒錶(SW),按 **▲** 鍵開始和停止秒錶,停止時按 **3** 鍵清零。在秒錶啟動時按MODE鍵可查詢各模式數據欄的數據。

#### 六、清除資料

在顯示DST模式時,按住 **▲** 鍵3秒清除DST,RAT,RT和SPDAVS的數據。

在顯示DST UP/DN模式時,長按 **▲** 鍵3秒清除DST UP/DN, TM UP/DN的數據。

同時按住 **3** 鍵與 **▲** 鍵則清除所有數據。

#### 七、自行車維護

當自行車使用一定的時間後,碼表會提示對自行車進行加油及維護,以保障自行車的性能和使用寿命。

當出現 加油圖示時請及時對自行車各部件進行加油維護,同時按下MODE鍵和 **▲** 鍵即可取消碼表的加油維護指示。

當出現 維護圖示時請及時對自行車各部件進行檢修維護,同時按下MODE鍵和 **▲** 鍵即可取消碼表的檢修維護指示。

#### 八、採樣模式

在任意模式下按 **▲** 鍵(秒錶顯示時除外)都將進入採樣模式,螢幕會顯示採樣模式的資料,DST,RT,SPD數值暫停,螢幕閃爍跳動顯示,繼續按 **▲** 鍵結束採樣模式。

#### 九、電池更換

當出現 圖示時,表示電池電量已不足請及時更換電池,以保障碼表的正常工作。

#### 十、背光功能

本碼表背光採用智能省電設計只要在每天的17:00~08:00時段內按任何按鍵背光都會亮4秒,讓你晚上也可隨時查詢數據,使你夜騎更出色。

#### 十一、常見故障排除

故障表現	原因	排除方法	故障表現	原因	排除方法
行復時表顯示速度始終顯示為"0"	安裝位置不正確 電池安裝錯誤 或電量不足	重新按裝安裝 或更換新電池 或更換新電池	顯示黑屏	曝曬時間過長	放置陰涼處自動回復
顯示屏時	電池電量不足	更換新電池	速度顯示不正確	車輪周長設置不對	重新設置車輪周長
			顯示反應遲緩	碼表處於零度工作	溫度高於零度回復正常

# User Manual

Dear Sir or Madam,

Thank you for buying our products and for your support. Please peruse this user manual before use of this odometer so that you can set it up and use it correctly.

Installation illustration (Please refer to the back side)

## 1. Parameter setting

First, measure the wheel circumference. In the mode of DST or ODO, press **⏻** for 3 seconds to enter the Parameter Setting mode. In the mode of Parameter Setting, **⏻** is for confirmation and **⏮** is for switch or adjustment. Press and hold **⏻** for 3 seconds to enter the mode of Setting. First, set the temperature. Press **⏮** key to choose from the Celsius/Fahrenheit systems, and press **⏻** key to confirm. Second, set the time. Press **⏮** key to choose from 12h/24h time systems, and press **⏻** key to confirm; when the hour value flashes, press **⏮** key to adjust the value, and press **⏻** key to confirm; press **⏮** key to adjust the values of the minute and the second in order and press **⏻** key to confirm. Third, when the wheel circumference is ready to be set, press **⏮** key to change the flashing value, and press **⏻** key to confirm and continue to set the value in the next place. The values range from 0cm to 999.9cm (preset as 208.0cm). Fourth, after the circumference is set, press **⏮** key to switch between the metric (Km) and imperial systems (Mile), and press **⏻** key to confirm. Fifth, set the total distance (ODO). Press **⏮** key to adjust the flashing value, press **⏻** key to enter the value in the next place from the ones, tens, hundreds to thousands (default 0000). Sixth, set the trip time (TT). Press **⏮** key to adjust the flashing value, press **⏻** key to confirm and continue to set the value in the next place. When the trip time is set, the working status of DST appears.

Note: when no setting is made within 15 seconds in the setting status, the DST mode status will cut in.

## 2. Function review

### I. Mode switch

The default status of the odometer is DST mode with the RAT and RT data displayed alternately. Press MODE repeatedly, and the DST mode, DST UP/DN mode and ODO mode will be displayed in a cycle.

### II. Data review

+ In the DST mode, the trip distance (DST), accumulated riding time (RAT), RT (riding time) and current time can be reviewed. In the standby status, the average speed (SPD AVS) shows and in the working status, the real-time speed (SPD) shows.

+ In the DST UP/DN mode, the count (UP) or countdown (DN) of the trip distance (DST), the count (UP) or countdown (DN) of the riding time (TM), the current time and real-time speed (SPD) can be reviewed.

+ In the ODO mode, the accumulated trip distance (ODO), accumulated riding time (TT), current temperature (Th) and maximum speed (SPD MXS) can be reviewed.

## 3. Use of stopwatch

In the modes of DST and ODO, press **⏻** key to start the stopwatch (SW). Press **⏮** key to start and stop the stopwatch. Press **⏻** key to zeroize all data. When the stopwatch is started, press MODE key to review the data in all modes.

## 4. Replacement of battery

When the  icon appears, the batter is running low. Please replace the battery in time to secure the odometer's normal operation.

## 5. Clear the data

In the DST mode, press and hold **⏮** key for 3 seconds to clear the DST, RAT, RT and SPD AVS data.

In the DST UP/DN mode, press and hold **⏮** key for three seconds to clear the DST UP/DN and TM UP/DN data.

Press **⏻** key and **⏮** key at the same time to clear all data.

## 6. Bicycle maintenance

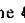
When the  icon for adding oil appears, please add oil to the parts of the bicycle in time. Press MODE and **⏮** at the same time to cancel the odometer's oil and maintenance indicator.

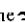
When the  icon for maintenance appears, please inspect and repair the bicycle in time. Press MODE and **⏮** at the same time to cancel the odometer's inspection and repair indicator.

## 7. Backlight

With the intelligent energy-efficient design, when any key is pressed any time between 17:00 and 08:00 every day, the backlight of this odometer will be on for 4 seconds so that you can check the data any time even at night and have a more pleasant night ride.

## 8. Setting of the Trip Distance Count (UP) or Countdown (DN)

Press MODE key repeatedly to switch to the trip distance count/countdown (DST UP/DN) mode. Press **⏻** key to switch between UP and DN. When the desired mode is confirm, press and hold **⏻** key for 3 seconds to enter the setting of the trip distance (DST). Press **⏮** key to adjust the flashing value, and press **⏻** key to confirm and continue to set the next value. When DST is set, the setting screen of the riding time (TM) automatically appear. Similarly, press **⏮** key to adjust the flashing value, and press **⏻** key to confirm and continue to set the next value. When the riding time is set, the odometer will enter the working status in DST UP/DN mode.

## 9. Sampling Mode

The Sampling mode will be entered by press **⏮** key in any mode (except when the stopwatch is displayed). The screen will show the data in the Sampling mode. The DST, RT and SPD data pause and the screen flashes. Continue to press **⏮** key and end the Sampling mode.

## 10. Shutdown mode

The odometer will enter the Shutdown mode automatically when no riding signal is input within 4 minutes, with only the current time shown on the screen. When there is riding signal, or when any key is press, the mode before the shutdown can be resumed and all of the data before the shutdown remain.

周長表 (Circumference) : MM									
車輪規格 (Wheel)	周長 (Cir)	車輪規格 (Wheel)	周長 (Cir)	車輪規格 (Wheel)	周長 (Cir)	車輪規格 (Wheel)	周長 (Cir)	車輪規格 (Wheel)	周長 (Cir)
700X40C	2224	700CX23C	2133	28X1 3/8X1.2205	27X1 1/4	2199	28X2.80	2114	26X1
700X35C	2205	700CX20C	2114	28X1 1/2	2268	26X3/4	1954	26X1.9	2089
700X32C	2174	700CX18C	2102	28X1.75	2268	26X1 3/8X1.2086	26X1.75X2	2072	24X1 3/8X1.948
700X28C	2149	700CX14C	2130	28X1.5	2224	26X1 3/8	2105	26X1.6	2051
700X25C	2116			27X1 1/4F	2174	26X2.125	2133	26X1.5	2026

## Common Troubleshooting

Failure	The speed is always displayed as 0 on the screen during a ride	Black screen	Incorrect display of the speed and distance	Dark screen
Cause	Incorrect installation location Incorrect installation of battery or low battery	Exposure to sunlight for too long time	Incorrect setting of the wheel circumference	Low battery
Solution	Reinstall as per requirements Install the battery correctly or replace it	Return to normal automatically when in the shade	Reset the wheel circumference	Replace the battery