

User Manual

Car entertainment and navigation system

Multimedia

Car GPS navigation system

User Manual

**CAR ENTERTAINMENT SYSTEM
THE BEST CHOICE**

**CAR ENTERTAINMENT SYSTEM
THE BEST CHOICE**



Thank you for choosing the Car audio & video navigation system from our company

When you use this product, please read carefully all the information we supplied, this manual introduced all the main functions and operation method, by this manual, you can obtain the information about products functions and specification, help you to operate the product correctly.

The displayed example picture in this manual maybe a little different from the actual picture.

The displayed example content in this manual may be a little different from the actual content.

If any parameters change due to products continue to be updated, the product will be supplied without any advance notice. Any problem, Please check the details with the agent, thanks for your support and cooperation

NOTE: The information of this manual protected by copyright, any part of it without company prior written permission is not permitted in any way to copy and photocopy. The company reserves the final explanation about the warrant and relative information in this manual.



- 1> Before the operation 01**
 - 1. Notice for safety items 01
 - 2. Notice before installation 02
 - 3. System installation 03
 - 4. Other notice 05
- 2> Basic operation 09**
 - 5. Introduction of Panel button function 09
 - 6. Turn on/off the host/Main menu 10
 - 7. Radio function operation 11
 - 8. DVR-Car recorder/OBD 12
 - 9. Bluetooth hands-free communication function operation 13
 - 10. USB function operation 15
 - 11. iPod features operation 16
 - 12. Calculator operation functions 16
 - 13. SD card function/GPS function operation 17
 - 14. DVD function operation 19
 - 15. Games function operation/Phone link/AUX 20
 - 16. Application volume setting function operation 21
 - 17. Internet setting/Internet explorer function operation 22
 - 18. World clock functions Instructions/Date time zone setting function 23
 - 19. Steering wheel setting function operation/System setting 24
 - 20. Touch adjust Setup/System upgrade function operation 25
 - 21. Restore factory setting 26
 - 22. language setting function 26
- 3> Troubleshooting 27**

**Warning**

- In order to avoid accidents, a possible violation of applicable law, do not use other other function as purpose expect navigation when driving.
- In some areas, it is illegal for the drivers or other people in car to watch the display.

Notice for safety items

- In order to avoid any injury or property damage of the user or otherpersons, please be sure to read in details and abide the following item.

- 1) Read the Manual.
- 2) Take good care of the Manual for future use.
- 3) To comply with all the warning and notice of this manual.
- 4) To comply with all operating instructions.
- 5) Regarding the power supply, please refer what the manual stated.
- 6) To ensure safety, commissioned by professional technicians for installation and wiring.
- 7) There is not any parte attached with the products for user to repair and replace, please ask the professional technician with qualification of maintenance to repair and replace.
- 8) Ventilation: Do not plug any Ventilation cooling vents, the local shell holes and other openings are for ventilation of heat. In order to ensure machine works stable and reliable, not to plug the hole cooling, ventilation environment must be maintained to avoid overheating the machine caused by smoking, fire or other danger.
- 9) Avoid heat source: heat source should be avoided and products will be not installed on local exposure to direct sunlight, high temperature areas; To be away from heat sources, such as heating, heat or have other things (including magnifier).
- 10) Avoid Water or Moist: device should avoid water or moist, do not let this machine being exposed to rain or moisture in the environment (as when rain and car washing) to avoid the internal machinery of the short circuit caused the fire, electric shock or other danger.
- 11) Cleaning: before cleaning machines have to shut down power, and then wipe panel, Do not use volatile chemicals (such as gasoline or thinner) to clean.
- 12) Avoid the matter or water into the device. To prevent foreign matter or liquid into the inside of the machine, do not insert the foreign body from the cooling hole or other opening into the machine. If you insert foreign bodies may cause electric shock, machine parts

within a short circuit caused the fire, such as the risk of electric shock.

- 13) Installation device. Do not install the unit to the truck, frame, tripod, bracket or table without the manufacturer's recommendations, should be installed on the install fittings which come with machines. When used in the car, pay more attention to firm the installation of this machine, avoid the machine falling down, because of the sudden brake and resulting in personal injury.
- 14) Don't operate the machine in the event, if rain or lightning for a long time, have to cut off the machine power.
- 15) Appear in the following situations, please turn off the local power supply in time, and contact with professional technician.
 - A. When the power wire or connector damaged;
 - B. When the machines were splashed with liquid or when the entry of foreign matter;
 - C. when the machine has been rained or moisture attack.
 - D. when the machine crashed from a height or as a result of abnormal operation or unreasonable damage caused.
- 16) LCD Display: do not let the machine decline to avoid LCD screen fragmentation, if so, when the outflow of liquid crystal, do not touch the liquid crystal, so as not to be harmed. Do not heat the liquid crystal display or scratching LCD with sharp objects, touch panel is also susceptible to scratching. The effective pixel of LCD screen is more than 99.99 percent, but 0.01 percent of the pixels could not be lightened normally.

Notice before installation

- Products of the manufacturers recommend that you do not install or repair their navigation systems by yourself. Installation and maintenance of the product may cause you in danger of electric shock or others, for all installation and maintenance operations of this navigation system please entrust to the service center authorized by manufacturer.
- Forbid to use the following dangerous installing ways and location:
 - 1) When the car in a sudden stop may cause injury on the driver and passengers.
 - 2) To avoid the possibility that impeded the operation of the vehicle drivers, such as the driver front seat or the steering wheel, stick shift.
- Before opening the hole from faceplate in the dashboard panel, make sure that the rear space is enough. Be careful, not to damage the fuel cable, brake cable, electrical components, power lines or cable communications.
- When use the screws, please ensure that they are not contact with any electrification down-lead. Vibration may have damaged wire or insulation skin and lead to a short circuit or other damage to the vehicle.
- In order to ensure proper installation, use the standard method of installation of the required components. If you use any non-standard components, this product can be internal damaged or loose components, leading to damage of the product.
- If the GPS antenna may lead to the winding column or stick shift that would be very

dangerous. Please ensure that the installation of the product will not disturb driving.

- Please ensure that all leading cable will not be caught by the doors or sliding framework in the seat, so as not to cause a short circuit.
- After finish the installation of navigation systems, please check vehicles and other equipment is correct.
- Some countries may prohibit or install or use of use of the system in the vehicle. Please comply with all the rules related to the application of laws and regulations when using, installation and operation of the navigation system.
- This product will be installed in the position between the driver's seat and passenger seat in order not to avoid any damage on the unit by driver and passenger when the car suddenly brake.
- Never install this product on the dashboard, door or columniation and girder, and the position the air bay expanding out and nearby, Please refer to your vehicle owner's manual to find out the area front airbags expanding.
- Do not install this product on the location may prevent the vehicles, including airbags, pillows and any operating system performance.
- Avoid the electromagnetic interference: In order avoid Electromagnetic interference, please try to stay away from the following components of this produce. cable or other wire. (FM, AM antenna and its wire , GPS antenna and its wire) And you should arrange every wire to stay away from each other, not make it colligation or cross-banding together. EMI will increase the possibility of the battery negative.

2) To install an external antenna (on the car), GPS antenna will be placed in the level position as far as possible, such as roof or cover suitcase department . (by a fixed magnetic body)(picture-03)

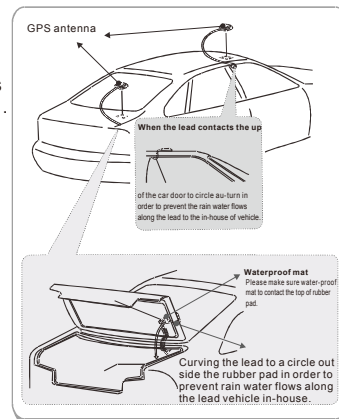

(picture-03)

⚠ Note: do not damage or dirty the dashboard

➤ The installation of GPS antenna

1) To install the antenna in the inner of the car (on the near shell). Please try to make the metal Plate stick on the horizontal lever so that the GPS antenna towards the window. GPS antenna will be placed on the metal plate. (GPS antenna fixed by magnetic)(picture-02).

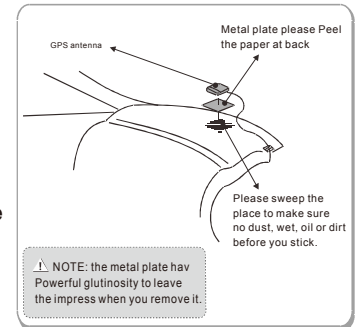

(picture-02)

➤ Description of Buttons on Remote Control

1. POWER
2. MODE
3. BAND/TA
4. UP
5. LEFT
6. ENTER
7. STOP
8. DOWN
9. AMS/REPEATING
10. PROGRAMME
11. PLAY RANDOM
12. TUNING/PREVIOUS SONG
13. PBC
14. OSD
15. MUTE
16. PLAY/PAUSE
17. SUB-T
18. DVD MENU
19. SETUP
20. RIGHT
21. SLOW
22. ANGLE
23. ZOOM
24. VOLUM UP
25. TUNING/NEXT SONG
26. AUDIO Effect Setting
27. AUDIO
28. VOLUM DOWN

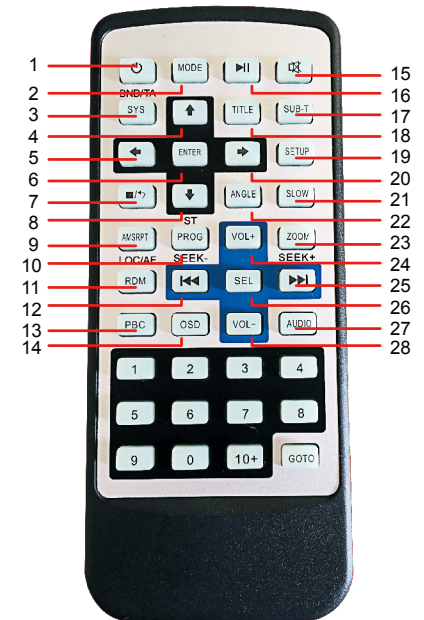

- 1
- 2
- 3
- 4
- 5
- 6
- 7
- 8
- 9
- 10
- 11
- 12
- 13
- 14
- 15
- 16
- 17
- 18
- 19
- 20
- 21
- 22
- 23
- 24
- 25
- 26
- 27
- 28

Unit socket sketch map

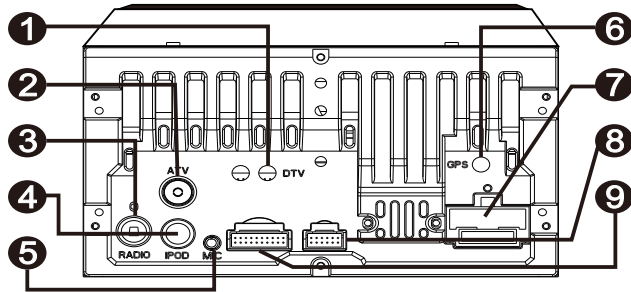

- | | |
|---|--------------------------|
| 1.For Digital TV Antenna(Optional) | 6.For GPS Antenna |
| 2.For Analog TV Antenna(Optional) | 7.For POWER |
| 3.For Radio Antenna | 8.USB+DVR+OBD |
| 4.For IPOD | 9.RCA+3G/USB |
| 5.For MIC | |

7

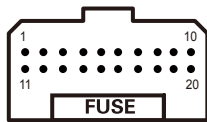

- | | |
|--------------------|---------------------|
| 1.SPEAKER FRONT L+ | 11.SPEAKER FRONT R+ |
| 2.SPEAKER FRONT L- | 12.SPEAKER FRONT R- |
| 3.SPEAKER REAR L+ | 13.SPEAKER REAR R+ |
| 4.SPEAKER REAR L- | 14.SPEAKER REAR R- |
| 5.BRAKE | 15.GND- |
| 6.ILL | 16.B+ |
| 7.WKEY1 | 17.ACC |
| 8.WKEY2 | 18.ANT_CTRL |
| 9.BACK | 19.CAN_RXD |
| 10.AMP_CTRL | 20.CAN_TXD |

8

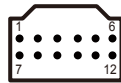

- | | |
|-----------|-----------|
| 1.GND | 7.DVR_12V |
| 2.ACC | 8.DVR_IR |
| 3.OBD_RXD | 9.DVR_VIN |
| 4.OBD_TXD | 10.GND |
| 5.USB_DM | 11.GND |
| 6.USB_5V | 12.USB_DP |

9

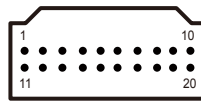

- | | |
|-------------|------------------|
| 1.3G/USB_DM | 11.3G/USB_DP |
| 2.USB_5V | 12.USB_GND |
| 3.AV_OUT1 | 13.AVOUT_GND |
| 4.AV_OUT2 | 14.AVIN_GND |
| 5.AV_IN | 15.CCD_VIN |
| 6.AUX_RIN | 16.AUXIN_GND |
| 7.AUX_LIN | 17.SUBWOOFER_OUT |
| 8.RR_OUT | 18.AUOUT_GND |
| 9.FR_OUT | 19.RL_OUT |
| 10.FL_OUT | 20.AUOUT_GND |

- ➔ The DVD Disk format
The DVD player can play DVD disk which have marked format as following (picture-05)

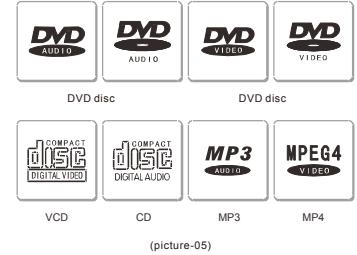

- ➔ The maintenance of the DVD player

Please use the conventional circular disk, not to insert irregular noncircular disk, otherwise these disks may be stuck inside the DVD player, or the DVD player may not correctly play. please check before playing on the disk if there is cracks, scratches or curly. such discs may not play and lead to product failure.

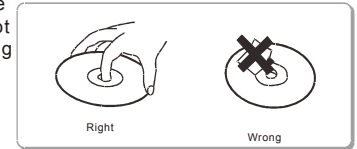

Do not use this type of disc.
Using disk, do not touch the recording surface (nonprinted surface).
Please put the disk in the box if it's not in use.
Please don't put the dish far away from the direct sunlight and high temperature place. Please don't put the label, write, paint on the disk surface, or use chemicals on the disk.
Please use soft dry cloth to clean the disk from the centre

To outside. The DVD player is likely to be internal components moisture if the car using central heating. The dew may cause DVD player can't work properly. So please stop the unit about 1 hour to make the unit clean and dry, if you find the fault like that. And clean the moisture on the disk with soft cloth. The DVD may be disrupted if the car running on a bumpy road.

➤ DVD disk

Regarding some disks, maybe can't use the some special function. Maybe can't play some disks.

➤ DVD digital multi-functional disk

DVD can Process for the movie software with large capacity and digital signal, which is a disk stored in high definition and High-quality integrated media.

➤ DVD menu

DVD can show couple of titles, the titles menu. Besides, DVD title menu can make some kinds of items shown, the sub-menu came out during the playing, the Dolby Digital and PCM audio, caption, language changed according to the software. While the unit play DVD-R/DVD-RW disks, it only play video format(under video mode), not play the PC files.

DVD-R/DVD-RW disks recorded may not play properly due to the property of disk, scratches or dirt or dew on the lens of unit. Disk recorded on personal PC maybe not worked properly, it depends on the setup and environment of the application format , therefore please a proper format of recording.

➤ CD-R/CD-RW disk

The DVD player only play completed CD-R/CD-RW Disk. CD disks recorded on personal PC recorded may not play properly due to the property of disk, scratches or dirt on disks or dew on the lens of unit. Disk recorded on personal PC maybe not worked properly, it depends on the setup and environment of the application format, therefore please use a proper format of recording. (For more information, please contact Applications Manufacturers) CD-R/CD-RW maybe not work properly direct sunlight or being in high temperature storage place in the car. The DVD player can't be worked properly with Recorded CD-R/CD-RW Disk's title and information data. (under Audio data CD-DA). You will wait long time for CD-RW Disk comparing to traditional CD or CD-R. Please look at the notice before using CD-R/CD-RW notice.

➤ Mp3 files(CD-ROM)

Mp3 is a kind of audio compact method, which should be brought into Audio level 3 in the





MPEG standard. The audio compact method has already been in the depth of personal computers as a standard mode. MP3 can compact original audio data to 10% of its initial size to keep the voice in high quality. This means that about 10 Track CDs can be recorded on a CD-R disk or CD-RW disk. In this case, there is no need to constantly change CD disks for playing for a long time. This player allows the playing of MP3 files on CD-ROM, CD-R and CD-RW disks as well as the content of any disks compatible with ISO9660 Levels 1 and 2 and ROMEO and JOLOEY file system. It can play the disks recorded compatible in multiple sections. MP3 files are incompatible with the transmission of data written in groups. The maximum number of characters that can be displayed as names of files 32 characters (calculated from the first character). The maximum number that can be displayed as the name of a folder is 32 characters. If a file is recorded in the ROMEO and JOLIET file system, it can display 32 character only. When a disk with Mp3 files and audio data (CD-DA), for example, CD-EXTRA and MIXED-MODE CD. They can switch between MPEG and CD-DA to play these two types of discs. The selection sequence of playing and other folders being operated will become the writing order used by writing software.

⚠ Notice: When one MP3 file is named, please add the corresponding file extension name (MP3). This play will play the files with the extension name (MP3) as MP3 files. To prevent noise and failure, please do not use such an extension name for non MP3 files.

➤ Setting function

Click "▶" icon into the quick selection interface

Click to enter, easy to operate.

-  GPS Interface
-  Bluetooth interface
-  Radio interface
-  DVD interface
-  SD card interface

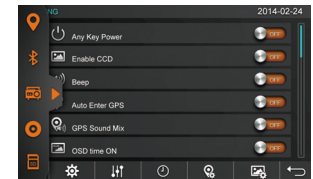

Quick switch

Introduction of panel button function

➤ 【Power】 button

When the player is off, the player will be on/off by long pressing Power button; The player will Enter silent mode by short pressing Power button.

➤ 【HOME】 button

In any function interface, press HOME button to back home

➤ 【NAVI】 button

When power on and having navigation card, press NAVI button, can enter Navigation mode.

➤ 【DVD】 button

When power on and there is disc in the machine, press DVD button, can enter DVD mode.

➤ 【▲】 button

When power on, there is DVD discs in the machine, press this button to eject the disc.

➤ 【BAND】 button

When power ,press BAND button to enter audio mode.

➤ 【 BT 】 button

When power on, press BT button, can enter Bluetooth mode.

➤ 【AMS】 button

When turn on the radio, press AMS button, can enter radio auto scan mode

➤ 【MUTE】 button

When power on, press MUTE button, can enter Silent mode.

➤ 【System Reset】 button

Use Fine-tipped object to top press inside the hole, press system Reset button to Factory Initial Setting. System Reset button for RSE.

Note:Our company's products, some models have the volume control buttons, some models have volume adjustment, and some have touch screen without volume control buttons and knobs. See you purchase specific set of products in kind.

Turn on/off the host

➤ Starting up

If the player power off by pulled out the car key last time, when you insert the car key again, the player will be power on automatically. If the player power off by pressing POWER button last time, the player will be power on by pressing the POWER button.

➤ Power off

The system will be power off automatically by pull out the car key. The system will be power off by long pressing power button.

Main menu

1) When powered on, the system will enter the main interface by default, under other function interface, touch the HOME button on the panel to enter main menu.



Main interface 1

2) In main interface, the upper part display the current date time, directly click to set.

3) All application icons interface can be padding page

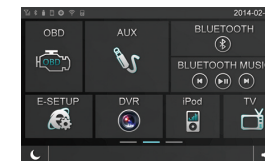

Main interface 2

4) Click the left corner of screen to adjust brightness.

5) Click the right corner of screen to adjust mute.

6) Click the main interface into function setting interface

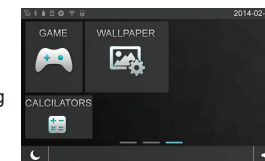

Main interface 3

⚠ Note: Navigation system usage complex with environment, may cause errors due to external electromagnetic interference. Navigation can't operate if there is no map card in the GPS sd card slot.

Radio function operation

Enter/exit

On the main menu, touch the "RADIO" icon to enter radio menu.



Touch "←" icon to exit the radio menu. After exiting the radio menu, radio continue to play in the backstage.



Radio-FM 1

Keyboard functions operating

The keyboard function including RDS, AF, TA, PTY, PTY SCAN, ST and so on.

1) RDS:RDS is a special wireless radio system developed by BBC, called "Wireless data broadcasting system", which only could be used in Europe area.

2) AF: Replacement frequency table, AF table shows that inside the same or a neighboring receiving zone, it broadcasts the information of same program's each transmitter. The receiver is stored and reduce frequency of search and replace of time, which is particularly useful for mobile reception.(This feature must support RDS function)

3) TA: Traffic Announcement identification: indicate whether being broadcast traffic bulletin, the receiver use this signal automatically switching to the program of traffic bulletin after broadcasting, back to its original working condition (This feature must support RDS function).

4) Type of program is a program type identification code, accompanied by every program and transmit, indicating what kind of radio program is being broadcast in 31 genera Click here to accept the identification code and record it, this program must support RDS function.

5) ST: Stereo function;

6)LOC: control the local radio station and the remote radio reception, on the LOC cannot receive radio signals over a long distance.

! Note : under the factory test mode, you can set the radio region selection (specifically reference to the factory test mode setting function)

Search

Touch "FM" / "AM" icon into Low frequency/ High frequency semi-automatic search mode.Click one time to start to search, click again to stop it.

Directly drag "FM" icon also can enter to Low frequency/ High frequency semi-automatic search mode After receiving station, the search automatically stores.

Band search

Click "Q" icon to select switch band, and you can switch between FM (MHZ) AM (KNZ) band



Radio-search

Band save

To choose radio station you like, click "SAVE" icon, you can save your favorite stations

DVR-recorder

In main interface, click "DVR" icon to enter DVR-recorder.

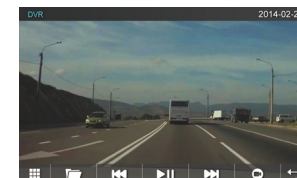

DVR-recorder

OBD

In main interface, click "OBD" icon to enter OBD- Vehicle information monitor

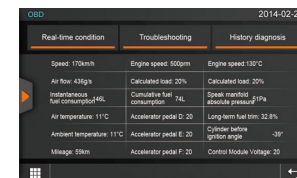

OBD

Bluetooth Hands-free communication function operation

- 1) The system supports with BT hands-free communication function. If your mobile phone equips with BT function, you can set up link the point to point with the system, dialing, answering phone, as well as playing music and other functions on the screen.
- 2) Since there are various brands of mobile phone, their BT module is different from each other. So when it comes to the practical use, some of the functions might be different, even some of them might not be compatible with our unit, please forgive for this.

Enter /Exit

In main menu interface, click "Bluetooth" icon into Bluetooth interface.

Click "Back" icon into exit.

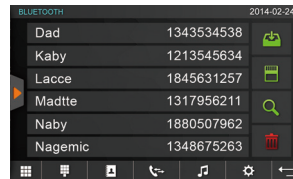

Bluetooth phone

Pairing and Link

1) Before using the BT hands-free communication function, please pair and link it with your mobile phone. Touch lightly "Bluetooth" icon into "Bluetooth setting"

2) Choose "Bluetooth" list, click "Bluetooth" icon, open Bluetooth, at the same time, please open BT function of your mobile phone, press "Link" icon, when the system is linked to the phone signal, your mobile shows on the screen. Link it and input the PIN code. After successfully match and link, an icon like

"Settings" will be shown on the bottom right of screen. Bluetooth pairing password is four zeros (0000)

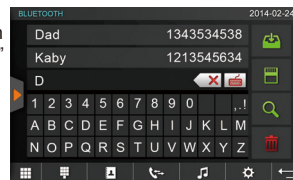

Bluetooth pairing

Make call

1) You can dial through your phone or by on-screen number buttons. As picture.

2) Input the phone numbers by screen buttons, when you input the wrong number, click

"Delete" icon to delete one by one. Press

"Call" icon to dial.

3) After dialing, answering the other side into the call interface, you can hang up.

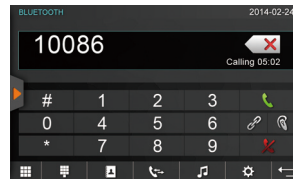

Make call

Answer

1) When there is a call incoming, the system will switch to BT and mute the sound to play incoming ring tone.

2) When there is a call incoming, you can choose answer, reject or mute, choose the answer into the call interface.

A) Letter / Pinyin / Handwriting Search In search interface, press "Search" to switch Keyboard, input the name of the alphabet first letter + the second letter (directly write your name), to find the number you need.

Click on numbers, dial icon

Conversion Bluetooth

1) When an external telephone is incoming, if using Bluetooth phone press "Bluetooth" button turned BT headset capabilities; If not using BT headset, turn to telephone.

In the search process, if input wrong, press "Delete" to delete one by one.

Phone Book

Press "Phone Book" icon into phone book interface, it will show all the number and support BT phone book, also will synchronize to the vehicle equipment via BT.

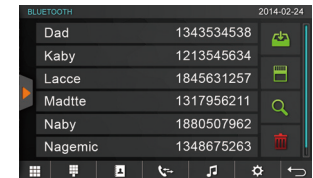

Bluetooth Phone Book

1) Download Bluetooth Phone Book

In phone book interface, press "Phone" icon, select "phone" or "SIM" card, press "confirm", then you can download the phone information to the host; List displays all numbers of phone book. Click on the number to dial.

2) Number search

In number interface, press "Search" to move up and down or padding up and down to search number, you can search for existing contacts by letter. Press "Search" icon into search function.

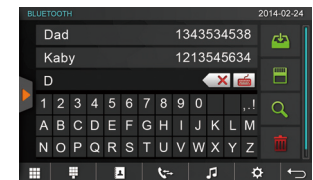

Bluetooth phone display

Bluetooth music play

1) If your phone equips with BT music play function, the music stored in your phone can be transferred to the unit's system and played by the system. Or press "  " icon into music play interface, if not connected, press blue-side to set "Please check. blue connection", after connected, enter BT interface.

2) Press "  " "  " into track selection "  " icon for Pause Play, "  " icon for play

! Notice: Only if the phone equips with the stereo connection or remote control function, the music play function can be realized. Besides, this function only can be operated when it comes to the BT music play interface.

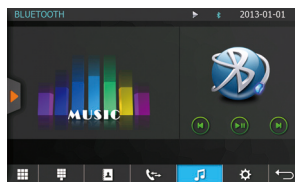

Bluetooth music play

USB function operation

In the main menu, click "  " icon to enter USB interface.

Touch "  " icon to return the previous interface

1) Touch "  " interface icon to enter the song of USB

2) Touch "  " icon to enter pattern interface.

3) Touch "  " icon to enter video interface.

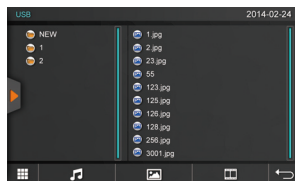

USB music

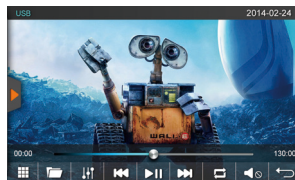

USB movie

iPod features operation



When connect the iPod to the unit, it will play the audio, video which contain in the iPod.

Enter /Exit

In the media menu, touch "  " icon and enter the iPod menu.

iPod main menu operation





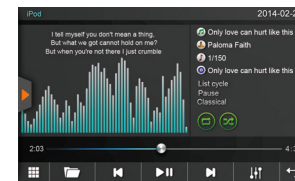

1) In the iPod menu, touch "  " icon and come to the iPod list menu.

2) Touch "  /  " icon to come to previous page or next page, or you can go through the screen vertically and to select the song you need and press it, then will play the song. Touch "  " icon again, then will come back to the playing interface.



iPod Playing

Definition of iPod function

 Step back  Previous  Next  Play/Pause
 File  Volume adjustment

Calculator operation functions

In the tool interface, touch "  " icon, enter calculator interface.

The calculator operating functions of the machine with the same method of operation of everyday use calculators.

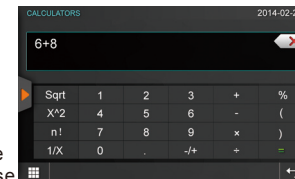

Calculator

SD card function

In the main menu, click "SD PLAYER" icon to enter USB interface.

Press "←" icon to exit options.

- 1) Press "🎵" icon to enter SD songs interface
- 2) Press "🖼️" icon to enter Pattern interface
- 3) Press "📺" icon to enter Video interface.

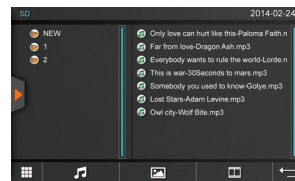

Sd card- music Reading

GPS function operation

➔ Enter /Exit

- 1) In main interface, press "NAVI" icon into GPS Interface.

When power on, insert Navigation card, click Settings, press "⚙️" button to enter Navigation Setting, select the Navigation program file you want to run, double-click to enter.

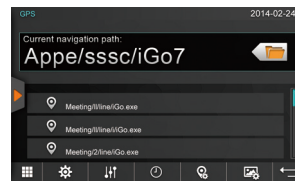

GPS setting

➔ GPS music function

- 1) During the radio/AV/DVD/TV process, switch it into GPS mode, the music will be played continuously when there is no GPS voice tips.

➔ Notes before GPS operation

- 1) Please ensure that right connection of the satellite antenna. Few minutes after the unit's on, the system will receive the satellite signal, update internal information and enter into the normal working Condition.
- 2) please make sure that the vehicle is not in the position where easily effect the signal receives such as under the bridge, in the tunnel or near the high building.
- 3) Driver should set up all the necessary steps before driving or ask the passenger to operate these functions

➔ GPS map instruction

- 1) With the quick development of the traffic roads and frequent changes of the traffic management information and equipment, the GPS map company will keep updating their map. Please pay attention to the update of the map. The guiding routes may be different from the live traffic situation; please drive according to the live road status, traffic controls and rules.

➔ About error

- 1) when the satellite signal reception is normal, the standard satellite positioning system error is about 7 meters. Driving on parallel sections, even though the auto-correct feature of this product maybe appear the deviation.

⚠️ Note : This function is effective when installing navigation module.

DVD function operation

This unit support DVD/VCD/CD/MP3/MP4/JPG/CD-R formats and so on.

➤ Enter /Exit

In the main menu, click “” icon to enter DVD playing discs.

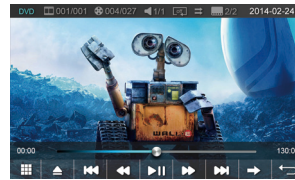

DVD

➤ Eject /insert the disc

- 1)When the screen show the letter, please put the disc into the DVD entrance, when the unit detected there is a disc, it will suck in and play the disc automatically.
- 2)When there is disc inside the DVD, press “” button, then the unit will eject the disc.
- 3)If you don't take away the disc in 15 seconds from the unit after eject the disc, the unit will suck the disc in and play it again.

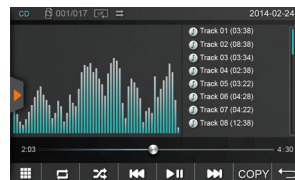

CD





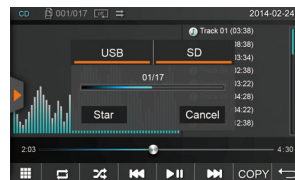



➤ VCDC function

Can read CD discs, reading process can be saved to the USB or SD card. You can copy music file from CD disc to USB or SD card, select the music, press “”, select USB or SD card and start the copy work.



CD copy

➤ Definition of DVD function

- | | | |
|---|---|--|
|  Order of play |  Random Play |  Come back to the main menu |
|  Previous |  Play/pause |  Video play |
|  Sound setting |  Next |  back |

Game function operation

In the main menu, click “” and enter game interface.

In the entering interface, you can directly choose “The monster war” game to play.

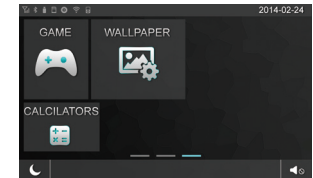

Game-main interface

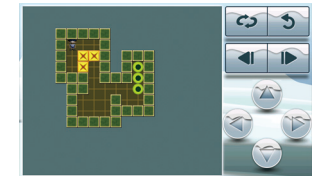

Game-interface

Phone link

In the main menu, click “” to enter Phone link interface.

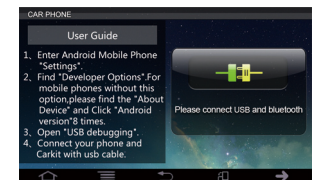

Main interface- Phone link

AUX

When the connection of external audio and video signals, the operation is to be effective.

➤ Enter /Exit

In the main menu, touch “” icon to enter AUX interface.

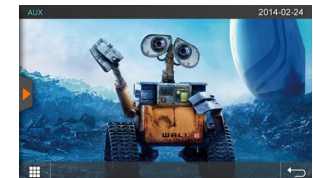

AUX

Wallpaper setting



- 1) In the main menu, click "Wallpaper" icon into background setting interface.
- 2) Select background setting picture area, press "Background setting" icon, set picture area you select into the main interface.
- 3) Choose your favorite picture, press "Confirm" icon to confirm the default saved as background
- 4) There is SD card inside navigation ,press "SD card" icon to enter the SD card picture, you can select the picture to set.
- 5)Wallpaper image formats: BMP, pixel: 800 * 480

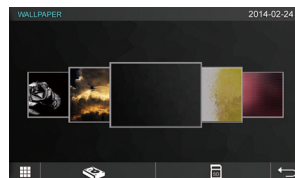

Wallpaper setting

Application volume setting function operation

Enter /Exit

Press setting, then enter the sound setting

- 1) Application volume setting can set sound for navigation TV, radio, Bluetooth, Audio, video, disc, VCD, IPOD, AUX1, AUX2, APP.

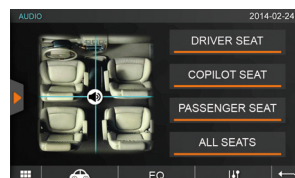

Balance

- 2) Drag "Volume" icon, can set the high, medium and bass tone, press "restore", the original audio will be restored.

Press "EQ" icon, can choose auto volume balance, and can randomly adjust volume channel

press "EQ" icon to balance EQ channel you can randomly adjust your favorite audio style and diverse sound on the car.

Press "Sound" icon to choose sound balance according to your favor to set.

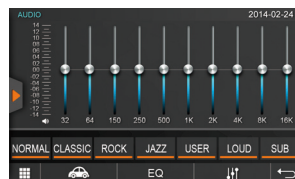

EQ setting

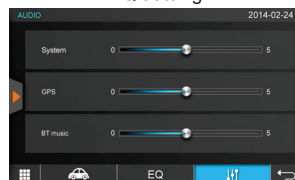

Mode Volume Setting

Internet setting

In Setting Menu, touch "Internet" icon to enter Internet Setting.



- 1) Touch "3G SETUP" icon into Internet setting interface, press CONNECE to connect to 3G network, after connection if successful automatically, upper left will appear "3G" icon.



- 2) Touch "WIFI SETUP" icon into WIFI Internet Setting interface, then you choose WIFI connection Input the password , it can be connected, after success,the upper left will appear "WIFI" icon.

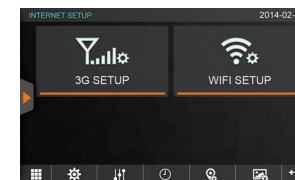

WiFi/3G Internet setting

Internet explorer function operation

Before enter into the Internet function, please connect with network equipment , touch "Internet setting" of "setting interface"(the operation of Internet setup, please refer to setup interface Operation), If it is successfully connected , an icon like "3G" / "WIFI" will be shown on the bottom right of the screen.

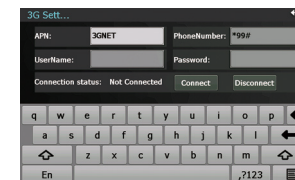

3G Internet setting

Enter /Exit

In main interface, press "Internet" icon into Internet explorer. On the web page, you can choose Internet pages according to your preferences.

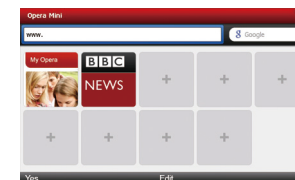

Network home

➤ Device setting function operation

In the device setting interface, click "device setting" interface.

1) Device setting includes device name, device performance, small lamp detection, brake detection, voice navigation, reversing function, reversing mute, reversing boot, automatically start recording, button tone type, button lamp color.

2) Choose needed setting function, click this function to finish setting.

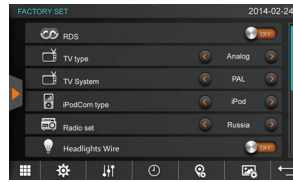

Factory setting interface

➤ Touch Adjust Setup

In setting menu, click "Touch Adjust" interface

Click the center lightly and accurately by a sharp point of pen or other stuffs. Target will automatically move until the screen adjustment is complete to exit.

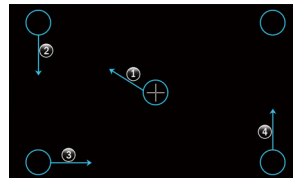

Setting interface-Touch Adjust

➤ System upgrade function operation

In the system setting interface, click "system upgrade" to enter system upgrade interface.

After clicking "confirm", it upgrade automatically! (Must insert upgrade card).

➤ Restore factory setting

In setting interface, touch "Restore Factory setting" icon into setting interface.

1) touch "Restore factory setting" icon to pop up The menu, then touch "confirm" icon to restore system, and the system will automatically restart.

2) After The system is restored to factory setting, Installed Third-party programs and all user data will be lost. Please restore the factory settings before user data backup system.



Restore factory setting

➤ Language setting function

In the system settings interface, click "language setting" icon, enter language setting interface.

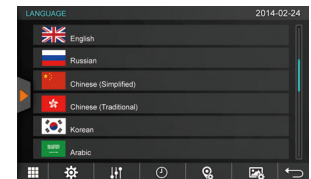

Language setting

⚠ Note: Please check "troubleshooting list" carefully before sending the broken device back to repair, also take appropriate measures to check or adjust simply. If the problem is out of list or still could not solve the problem, please feel freely to contact our professional after-sale team!

Phenomenon	Cause	Solutions
No power supply	Wrong connection between wires and connector	Make sure all connections correct again
	Broken fuse	Find out the reason of the Broken fuse; and then replace it with the identical fuse
	The build-in microprocessor is unable to work normally due to the noise and other factors	Press RESET to restore to the factory settings
Failure of remote control even if you press the right Remote control button on the unit still does not normal operation.	Low Battery	Replace with new batteries
	Certain functions are forbidden under specific modes	Enter the proper mode
Unable play the disk	Disk is dirty	Clean the disk
	The format of the disk is not compatible	Check the disk format
	The disk video system is not compatible	Change new disk is compatible with the video system
	Disk poor quality or damage	Replace the good quality disk
No sound	The cable is not properly connected	Re-connect the cable properly
Cannot increase the volume	The machine is running in still, slow motion or frame by frame playback	There is no sound output in still, slow motion or frame by frame playback
Particular Speaker cannot output sound	audio setup is not corrected	set the proper audio configuration
The DVD cannot display if appear the parent lockup message	Turn on the parent lockup function	Close the parent lockup function or change the setting level

Phenomenon	Cause	Solutions
Unable to Change Language (subtitle included)	Current DVD has no extra languages for selection	you can not switch to other language in a None Multi-Language disc
No subtitled	You can only switch it over to the options as shown in the disk menu	Use the disk menu for switchover
	No subtitle in this DVD	If there are no subtitles recorded for the disk, then it is unable to show subtitles.
	You can only switch it over to the options as shown in the disk menu	Use the disk menu for switchover
Failed to play back according to language in audio and subtitle selected in the DVD SETUP MENU unable to switch over to another viewing angle	The current DVD has no audio or subtitle language in the DVD SETUP MENU	If the disc is not recorded DVD SETUP MENU choice language, is unable to switch to select language
Unable to view angle switch	The current DVD has no a multi-viewing angle	if the disc is not recorded with more perspective shooting scenes, can't switch to other viewing in a NO Multi-viewing disc
	You try to switch it over to another viewing angle out there are no multi-viewing	Watch with more perspective recording scene switching angle
Picture is extremely unclear distorted or dim in the playback	The disc has a copy protection signal (some of the disc may have this feature)	Because the DVD and anti copy analog copy protection system, so if the player has a copy protection signal disc, then in some viewed on a monitor, the picture may appear horizontal strip or other, it does not mean that the issue of fault.
No image: PIC OFF is shown	You fail to connected the manual brake wires or fail to turn on the manual brake	Connect the brake wire and when turn on the manual brake
When the ignition switch is turned to the ON position (or to the ACC position) the player automatically switches on		This is a normal function