

SD-576C

FUNCTIONS ILLUSTRATIONS

Please note the slight rattle sound from device is normal phenomenon, which results from the design of wireless automatic function.

- SPD CURRENT SPEED
- ODO ODOMETER(0~9999km/m)
- DST TRIP DISTANCE
- MXS MAXIMUM SPEED
- AVS AVERAGE SPEED
- TTM TOTAL TRIP TIME
- TM TRIP TIME
- RAT RIDING ALL TIME
- CLK CLOCK (12H/24H)
- SW STOPWATCH
- TEMPERATURE
- TM UP TRIP TIME UP
- TM DN TRIP TIME DOWN
- TRIP UP TRIP DISTANCE UP
- TRIP DN TRIP DISTANCE DOWN
- COMPARATOR
- MAINTENANCE ALERT
- MACHINE OIL REMINDER
- OVER-SPEED REMINDER
- SETTING TYRE CIRCUMFERENCE
- SETTING THE LAST VALUE OF ODOMETER
- SETTING SPEED SCALE(km/h, m/h)
- LOW BATTERY INDICATOR
- FREEZE FRAME MEMORY
- AUTO BACK LIGHT
- WIRELESS DIGITAL CODE
- LCD BACK LIGHT
- SMART BACK LIGHT
- KEEP BRIGHTENING
- SLEEP MODE
- WIRELESS WAKE UP
- TOUCH SCREEN

HEAD UNIT ILLUSTRATION

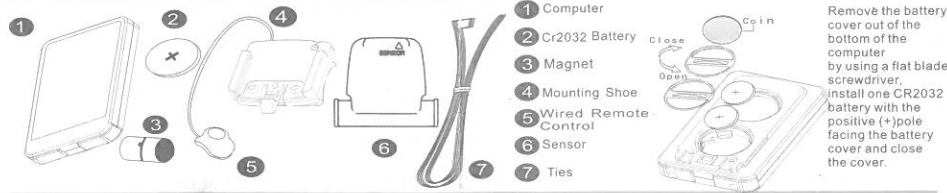

COMPONENT ILLUSTRATIONS



COMPONENT ILLUSTRATIONS

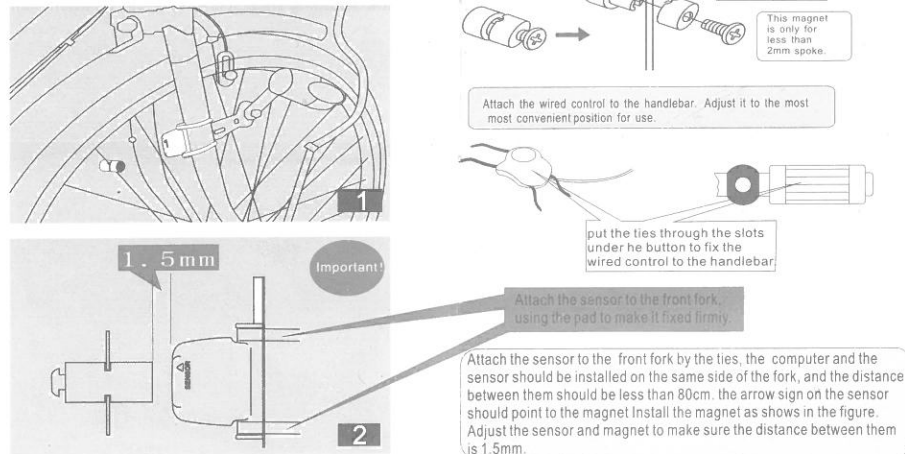

INSTRUCTION

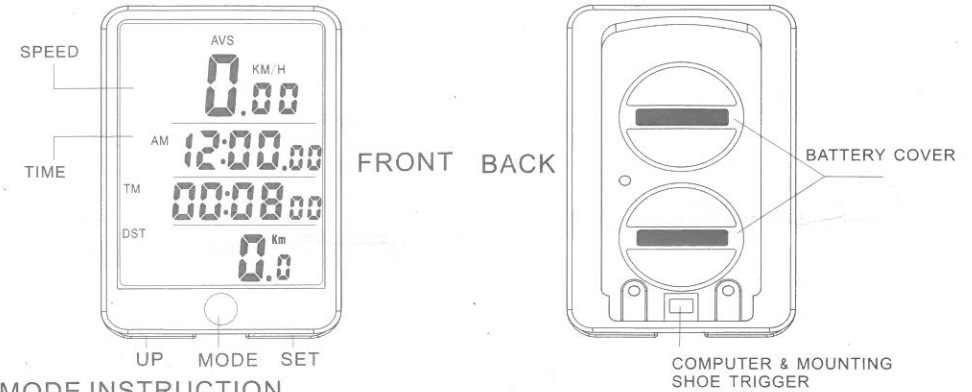

MODE INSTRUCTION

When battery is put in the computer, the display is in DST mode. It has three modes of this computer, DST, TRIP UP/DOWN and INQUIRY MODE. Each press of the MODE button switches into one of three MODES. The DST MODE is the default one.



MALFUNCTIONS AND REASONS

1. KM/H value keep 0 during riding
Improper magnet/wireless transmitter alignment, or the distance between the computer and the wireless transmitter is more than 80cm.
2. Inaccurate value is indicated
Take out the battery and reset it after 10 seconds.
3. Black display
Exposed to direct sunlight or high temperature environment for too long. Cold it down in a shadow for some time.
4. Display shows irregular figures
Poor battery contact or dead battery. Check and reset the battery or change a new battery.
5. Display readout fades out
The battery voltage is low, change a new battery.