

SHANNY

SN600C

Speedlite For Canon



INSTRUCTION MANUAL

Warning

- As the product has high-voltage components, please don't disassemble it by yourself. You can contact our after-sales service or sent it to the repair station if repair is needed.
- Please keep the product dry and away from wet hands. It cannot be immersed into water or exposed to rain or else it may fail to function.
- The product is related to battery. As for battery's usage and management, please refer to the corresponding operations specifications.
- Don't violently strike or shake the product, it may lead to product failure.
- Please don't flash it at close range directly to human eyes (especially infants' and young children's), otherwise it may damage the eyes or cause blindness.
- Please don't place this product in the car in which it will be under direct sunlight, as the temperature in these places will be very high, which is likely to cause damage to components.
- Please don't use the flash where there are flammable gases, otherwise it may lead to gas explosion.

SN600C New Functions

- The set-top E TTL flash: Install it on the Canon camera to achieve automatic flash photography.
- Optical signal SLAVE functions: Wireless remote M mode flash (optical pulse).
- Autofocus auxiliary functions.
- Automatic zoom function, flash zoom position can be back and forth with the change of the focal length of the lens.
- Supporting the access to the Canon menu.

Thank you very much for buying Shanny products.

Please read the instruction manual carefully before you install the SN600C on your camera, in order to achieve fully function of the flash and the camera.
After the installment of SN600C to SLR camera, you can set the function by access to the camera menu, or by manual control.

Quick Guide

- Automatic flash:** Set the flash to E TTL mode, can fully automatic flash photography.
- Light trigger slave unit (optical pulse):** Press [Z] button, set the SN600C to SLAVE, there are three choices SLAVE Canon/SLAVE S1 / SLAVE S2.
- The set-top flash:** Press [MODE], switch to E TTL, M, MULTI mode, the installed camera can be triggered flash.
- High-speed sync:** Press [SYNC] or through camera menu to set high speed sync, your camera can use any shutter speed.
- Auto Zoom:** Set A Zoom, flash zoom position can be back and forth with the change of the focal length of the lens. (20 ~ 200 mm)

Special Explanation

- SN600C flash as a set-top use, comprehensive support E TTL function. As off-camera used, only support wireless manual mode flash, but no TTL functions.
- ALL off-camera mode, SLAVE Canon / SLAVE S1 / SLAVE S2 support high speed with Step M mode flash.

Precautions about the continuous flash

- To prevent degradation and damage of the flash head caused by overheating, please do not continuously flash it for more than 20 times. After 20 times, cool it at least for 10 minutes.
- If you use it more than 20 times in a row to continue with a short interval repeated flash, the security function may be activated to limit the flash. In the restriction period, the recycling time is automatically extended. If that happens, please cool the flash for at least 15 minutes.

Component

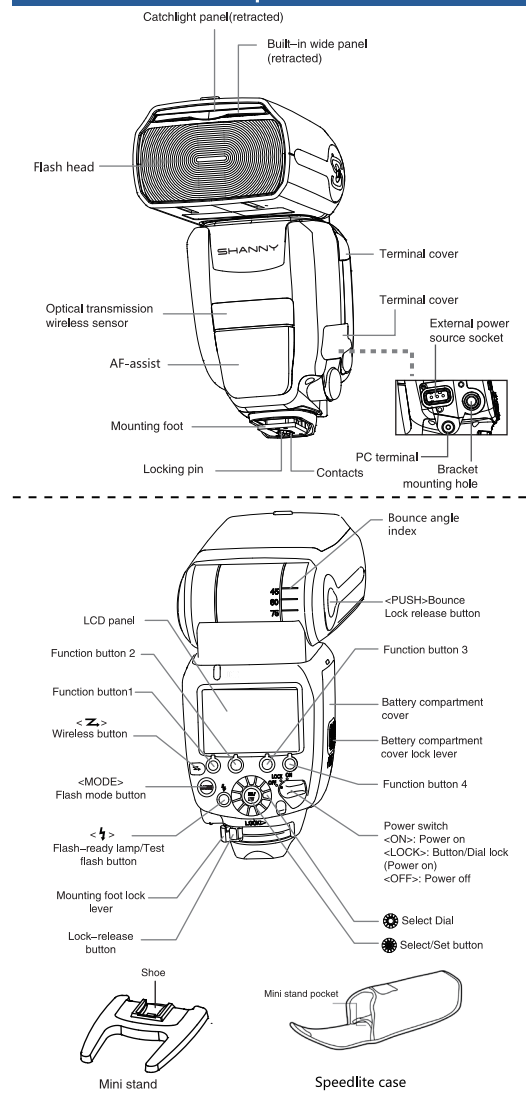

Main Display Interface

On-camera E TTL: Mount the camera for automatic flash photography

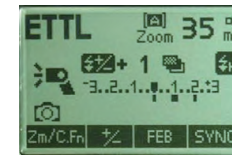

Optical trigger slave unit (optical pulse): Compatible [Canon optical pulse transmission system], support remote M mode flash, and high-speed sync.

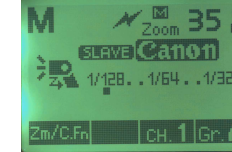

Off-camera light trigger (S1/S2): Use set-top camera TTL, M trigger mode, support high-speed sync.

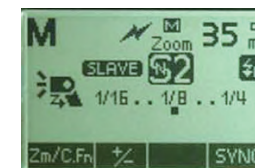

Preparations

Battery installation: Install four *5 (AA) batteries
According to the following steps to install the battery

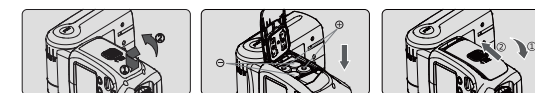

According to the instructions of battery, ensure the batteries' "+" and "-" contact towards the right direction.

Specification Parameters

- Guide number:** GN60 (ISO100 , 200mm)
- Wireless Flash:** Optical pulse transmission Slave
- Flash mode:** E TTL, M, MULTI
- Zoom range:** 20 ~ 200mm (When using wide angle dispersion plate is 14 mm)
- High speed sync:** 1/8000s
- Slave flash:** Optical pulse SLAVE Canon, light trigger S1/S2
- Shutter synchronization:** High Speed Sync, Front-curtain Sync and Rear Sync
- Flash exposure compensation:** Support (with an increment of 1/3 gear in +/-3 gear)
- Bracket exposure:** Support
- Flash exposure lock:** Support
- Modeling flash:** Support
- AF assist-focus:** Support
- Manual flash:** 1/128~1/1 (with an increment of 1/3 gear)
- Frequency flash:** 1 ~ 199Hz
- Recycle time:** Quick flash less than 2s, ordinary flash less than 3s
- Optical transmission distance:** About 20 m
- Optical transmission channels:** 4
- Flash groups:** Support for A/B/C groups
- Power supply:** 4xAAsize batteries (Alkaline or Ni-MH is usable)
- External interface:** Hot-shoe, PC synchronous interface, external charging interface
- Battery life:** Flash 100 ~ 700 times
- Measurement:** 79.7 (L) x142.9 (W) x125.4 (H) mm
- Net weight:** About 420g (not including batteries)

Normal set-top camera flash, press [MODE] to switch to E TTL/M/MULTI mode.



On-camera E TTL flash

Zm/C.Fn

Short press this button to set the changes of focal length changes, automatic zoom, or manually zoom 20 ~ 200 mm. Long press [Zm/C.Fn] is used to set custom functions, you can define flash function according to the demand. Such as sleep, auxiliary focus lamp, prompt, backlight, etc, select to set up project, press the corresponding button to set the 0/1/2 required functionality. In C.Fn 24, press the CLEAR to restore the default settings.

+/-

FEB

Press +/- button to set the flash exposure compensation (-3EV ~ +3EV) or brightness output (1/128 ~ 1/1), FEB to set the bracket exposure. Function adjustment is according to the current mode, based on the screen display.

A Zoom

Automatic zoom, flash zoom position can be back and forth with the change of the focal length of the lens. (20 ~ 200 mm)

SYNC

Sync shutter settings button, can switch to High speed sync, Rear sync and Front-curtain sync. [H] is for High Speed, [R] for Rear Sync, and Front-curtain sync is the default invisible. All flash mode of sync is set up in the same way.

Operate [Z] to set the flash to light trigger SLAVE unit.



SLAVE Canon

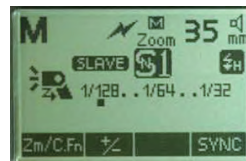

SLAVE S1



SLAVE S2

[Zm/C.Fn], [+/-], [CH.1] set focal length/custom functions, exposure compensation and telecommunication channels.

SLAVE Canon

It can be compatible with Canon Optical signal trigger system, the master flash adopts 580EXII/600EX-RT and camera Built-in flash optical signal to trigger.

CH.1

Setting button for communication channel, it can switch to CH.1 ~ CH. 4. The master and slave units set to the same channel.

Gr.A

Press this button to set the flash group A/B/C.

SLAVE S1/S2

S1/S2 optical trigger, the master flash can adopt the set-top camera TTL, M mode. S1/S2 mode's brightness can be manually set by the button of +/-, brightness range is 1/128 ~ 1/1. S1, S2 optical trigger mode can support High-speed sync. Press [SYNC] to set high-speed sync < [M] >.

Normal set-top camera flash, press [MODE] to switch to E TTL/M/MULTI mode.



E TTL LCD panel displaying this icon indicates that the current flash mode is E TTL. The camera and the flash can manage automatic metering to ensure the correct exposure, thus to make the subject and the background get balanced exposure. In E TTL mode, you can set the flash exposure compensation and Bracket Exposure in range of -3EV ~ +3EV, with an increment of 1/3 gear.

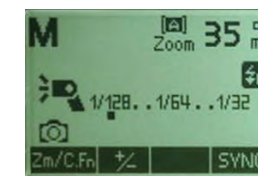

M LCD panel displaying this icon indicates that the current flash mode is M, which means setting the flash output manually. Setting range is 1/128 ~ 1/1, with an increment of 1/3 gear. Rotate the dial to the right or left to add or subtract.



MULTI LCD panel displaying this icon indicates that the current flash mode is MULTI, stroboscopic mode, which means using slow shutter to frequency flash light. It can shoot multiple continuous motions in one photo similar to animation shooting. You can set the flash output, guide number and flash frequency in stroboscopic flash mode.

Batteries can be very hot if replacing them after continuously flashing. When it displays < [M] >, please replace new batteries. Please use 4 batteries of the same brand. When replace them, please replace four. You can also use (AA/LR6) rechargeable hydrogen (Ni - MH) cells.

Install or remove the flash

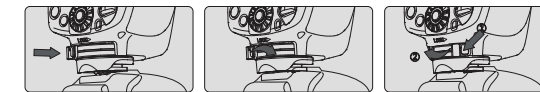

Please press the lock release button before install or remove the flash. After the installation, please lock the quick lock key, in case the flash would fall off.

Function Brief

SEL/SET

This option button can be horizontally rotated to adjust the parameters of flash, the right-hand rotation to increase set parameters, while the left-hand to reduce.

Z

[Z] can switch flash trigger mode, including set-top ordinary flash/ SLAVE Canon /SLAVE S1/ SLAVE S2.

MODE

[MODE] is flash mode button, to set the flash mode, it can be set as auto-flash E TTL, manual flash, frequency flash MULTI mode.

The content of this manual is formulated according to Shanny's internal test standards. If there are any changes in regard to product design and specifications, please understand there is no prior notice.



Manufacturer: **Shenzhen SHANNY Photography Optical Equipment Co., Ltd.**
Add: Room 1502, 15F, Dreamland International Center, He ping East Road, Longhua New District, Shenzhen, China 518109
Tel: +86 0755 23300778
Web: <http://www.szshanny.com>