

Tire Pressure Monitoring System Quick Installation Guide

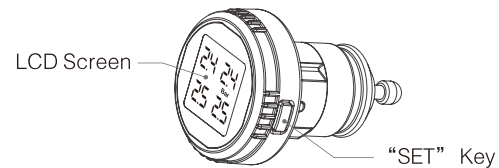

Product Assembly:

Display Key and LCD diagram

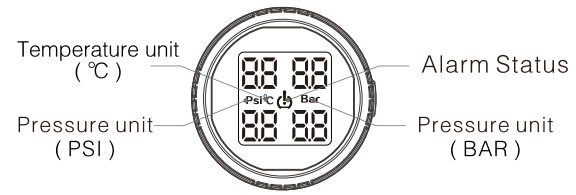

Product Accessories

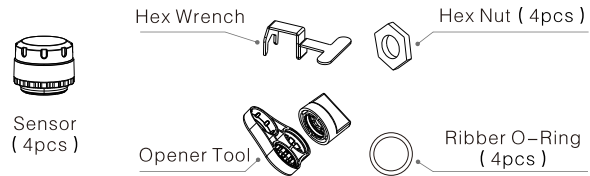

Display Installation:

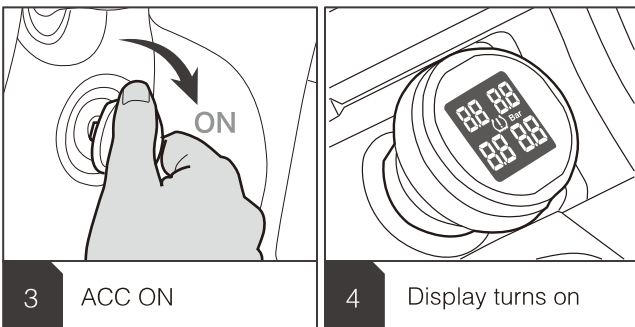
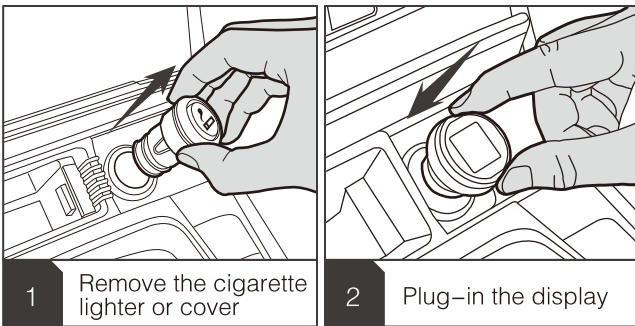

Sensor Installation:

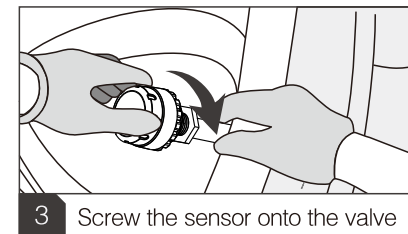
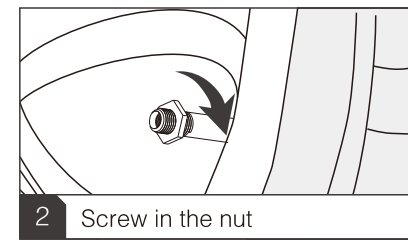
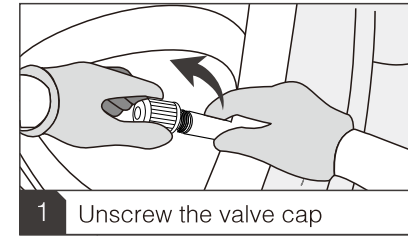

Sensor Installation:

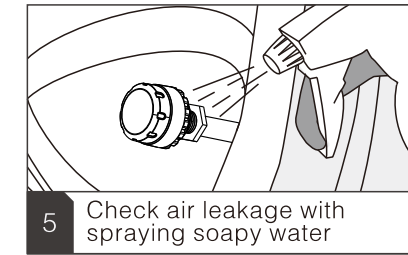
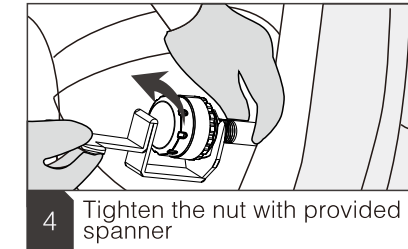

Functional Test after Installation:

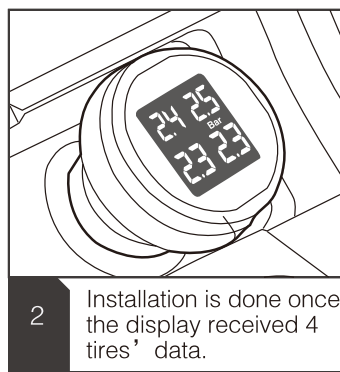
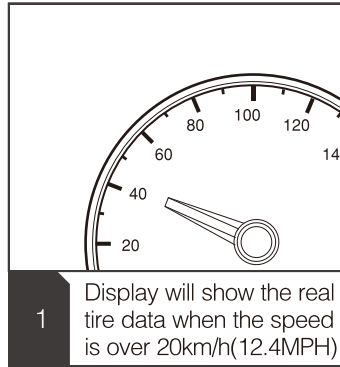

Alarm Status:

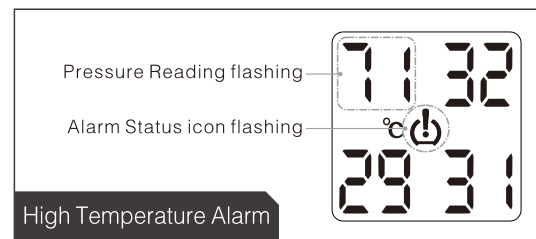
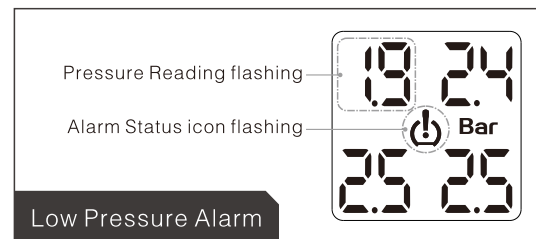
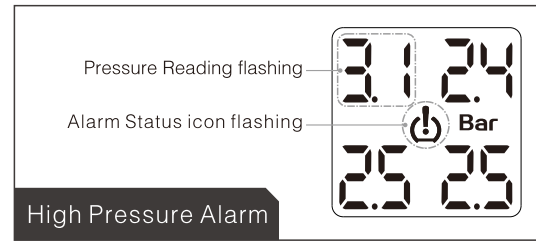

Alarm Status:

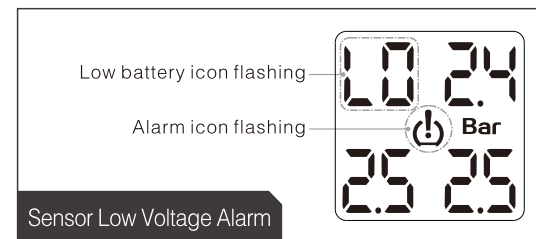
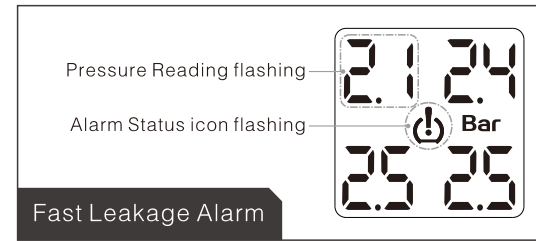

FAQ:

1.Q: Is the pressure and temperature reading accurate?

A: The unit is developed with freescale technology, which makes the unit reliable and provides accurate readings.

2.Q: Is the unit easy to install.

A: Yes, the external sensor is only 9grams, it's easy to install and no need balancing.

3.Q: What do I need to pay attention to during the installation?

A: The signal transmission from the sensor to the monitor is wireless, the transmission distance can be shortened due to the interference from other electronic devices that nearby the monitor. The monitor should be located far away the other electronic devices.

4.Q: What can I do if the pressure reading is "0" after the sensor is mounted onto the tire?

A: When the pressure reading is 0, please take the following instructions: ①Please check over the sensors and make sure the sensor is installed correctly. ②The reading will be updated when the speed is over 20km/h.

5.Q: What can I do when the display doesn't report the sensor data?

A: please take the following instructions: ①Keep the TPMS display far from the other electronic devices. ②Please go to code the sensors as per the inflation code learning in the user manual.

ATTENTION:

1.Due to the air expansion and contraction, the tire pressure and temperature will normally increasing 0.1-0.3bar while driving.

2.This unit is only suitable for the car that tire pressure is lower than 87PSI (6Bar), and it's not recommended to be used for caravan, trailer due to the transmitting range.

3.The unit has default pressure and temperature limits, and you can set the desirable pressure and temperature limits if you need.

4.Please stop driving and check the tire if there is continue alert happen.

5.The battery life is related to the driving distance. You will need to replace the battery only if the low battery icon shows on the monitor.

6.The unit can effectively monitor tire pressure and temperature but cannot avoid all traffic accident or tire blowout. Using quality tire product and monitor correct tire pressure is still necessary.

Technical Specification:

Monitor Specification

Default Pressure Unit	PSI
Default Temperature Unit	°C
Default High Pressure Alert	44PSI(3.0Bar)
Default Low Pressure Alert	29PSI(2.0Bar)
Default Temperature Alert	70°C
Working temperature	-20°C to +80°C
Storage temperature	-30°C to +85°C
Output Voltage	Dc12 to 24V
Frequency	433.92MHz
Size	33(φ)*50(H)mm
Weight	20g

Sensor Specification

Working temperature	-40°C to +80°C
Storage temperature	-40°C to +85°C
Pressure range	0 to 6bar(0 to 87psi)
Pressure Accuracy	± 0.1bar(± 1.5psi)
Temperature Accuracy	± 3°C
Transmission Power	< 10dBm
Transmission	433.92MHz
Battery life	≥2 Years
Dimenson	21(φ)*17.5(H)mm
Weight	9g