

AS SEEN
ON TV

PEDIPRO[®]
Deluxe



JML



Instructions

To fit batteries (batteries are not included):

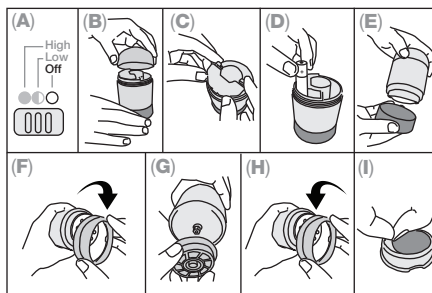
- Ensure power setting (A) is set to off
- Unscrew the top of Pedi Pro Deluxe® (B)
- Remove battery lid by lifting the tabs (C)
- Insert 4 new 1.5V AA batteries, carefully matching the plus and minus signs correctly (D)
- Place battery lid back onto the unit and screw back on



Instructions for first time use:

- Remove silver lid (E)
- Peel off the blue protecting film
- To the side of the Pedi Pro Deluxe®, turn the tab to the first setting low (A)
- Increase to the second setting once you are comfortable using Pedi Pro Deluxe®

To change steel blade to buffing disc:

- Remove the silver lid (E)
- Twist the pink protective plate clockwise on the Pedi Pro Deluxe® and remove (F)
- Pull off the steel blade and shaving tray (G) to reveal the rotary head while taking care to not accidentally switch on (remove batteries first if necessary)
- Place the buffing disc onto the rotary head
- Re-attach the pink protective plate onto the Pedi Pro Deluxe® and lock by twisting anti-clockwise (H)
- Turn the Pedi Pro Deluxe® onto the first setting, then adjust settings accordingly

Cleaning and maintenance

- To wash the steel blade and empty out the waste, first remove the silver lid
- Twist the pink protective plate clockwise on the Pedi Pro Deluxe® and remove (F)
- Pull off the steel blade and shaving tray (G)
- Twist the blade cap anti-clockwise and lift away from the shaving tray, while taking care not to spill any of the shavings held in the tray
- Dispose of the shavings and then wash with the blade in warm soapy water
- If needed, clean the buffing pad with a damp cloth. Take care not to get the exfoliating pad wet
- Allow to dry completely before re-assembling

To replace buffing pad:

- Peel back the existing buffing pad carefully from the buffer head. Work your fingernail under the pad to ease off (I)
- Un-peel the white backing off the new buffing pad
- Stick carefully to the buffer head
- Place the buffing disc onto the unit as per the instructions above

AS SEEN
ON TV



PEDIPRO®

Deluxe



Instructions

Product contents:

- 1 x Pedi Pro Deluxe®
- 2 x Stainless steel blade
- 1 x Buffing disc
- 1 x Shaving tray
- 1 x Moisturising cream pad
- 18 x Extra buffing pads
- 1 x Carry pouch
- 1 x Small cleaning brush

Caution:

- Read instructions provided before first use
- Do not immerse the main unit in water or any liquid
- People with long-term illnesses should consult their doctor before use
- Consult a doctor before use if you are a diabetic or suffer from poor circulation
- Take care when using for the first time – start by using slowly on the first setting and only move to the second setting if you experience no discomfort
- Keep away from children
- Persons with broken, damaged or infected feet should not use the Pedi Pro Deluxe®
- Hand contact with the spinning metal disc is not recommended
- Rest the head of Pedi Pro Deluxe® gently on your foot - excessive force is not necessary
- 'Kick back' from the device is normal
- For intended use only; not to be used as a hair removal device
- Wash hands after use
- This unit is intended for one person only due to hygiene reasons. We discourage sharing the unit with others

Replacement buffing pads:

- Extra buffing pads are available to buy from www.JMLdirect.com or Customer Services on freephone 0800 781 7831.

Battery Information:

- Do not dispose of in your household waste – contact your local authority for details of your local recycling schemes.
- Take care to fit batteries carefully, observe plus and minus signs and fit correctly.
- Ensure unit is switched off before inserting batteries
- Always replace a whole set of batteries at once, do not mix old and new.
- Always store batteries in the original packaging and away from metal objects which may cause a short circuit.
- Never dispose of batteries in a fire; they may explode.
- Always supervise older children when replacing batteries; ensure these guidelines are followed.

Guarantee: This product is unconditionally guaranteed for one year against all defects of workmanship and materials. This guarantee does not affect your statutory rights.

If you have any problems or queries about this product please contact JML's customer service department on freephone 0800 781 7831.

Made in China
© JohnMills.td/KY/05.12/ME/C

Distributed by JML
JML, Unit 1 Eastside, Port of Tyne, South Shields, NE33 5SP
info@JMLgroup.co.uk Freephone 0800 781 7831

Registered address:
JML House, NN5 3EG.
DC 6V (4 x 1.5V AA Batteries)



Shop online at JMLdirect.com