

Care & Maintenance:

- **WATER WILL DAMAGE THE FT Yes!** Do not use the unit in the shower, near water, or in a damp room.
- **DO NOT RINSE THE HEAD UNDER WATER!** To clean the head, use the brush that is included in the package. Make sure the unit is turned off.
- FT Yes should be switched off and stored in a cool dry place when not in use.
- For best performance, it is NOT recommended to use the FT Yes while it is charging.

MICROFOIL HEAD MAINTENANCE

To maintain optimal performance of the Microfoil Head, from time to time clippings trapped in the head may need to be cleaned out. The Microfoil Head is designed for easy removal and may be easily cleaned by removing the head from the FT Yes, then *gently* tapping the bottom of the head against a hard surface, such as a sink. The brush included with the FT Yes may be used to swipe out any remaining clippings. Compressed air, such as computer duster, may also be used to blow the clippings from the Microfoil Head.

The main body of the FT Yes underneath the head should also be brushed or blown clean any time the head is cleaned or changed.

TRIMMER HEAD MAINTENANCE

The performance of the Trimmer Head may be kept at optimal level with regular cleaning (as described above) and lubrication of the Trimmer Head. To lubricate the Trimmer Head, after cleaning, apply a drop or two of mineral oil (or baby oil) to the front edge.

Warning

- Keep out of reach of children.
- Exercise caution when using around eyes.
- The FT Yes contains a Lithium ion battery. DO NOT DISPOSE OF IN FIRE.

Usage:

Trimmer Head and Microfoil Heads

- Chin
- Toes
- Underarms
- Bikini
- Knees
- Calf
- Ankles
- Thigh
- Arms

This device complies with part 15 of the FCC Rules. Operation is subject to the following two conditions: (1) this device may not cause harmful interference, and (2) this device must accept any interference received, including interference that may cause undesired operation.

Notice: Changes or modification not expressly approved by the party responsible for compliance could void the user's authority to operate the equipment.

Distributed by:  Wayne, NJ 07470
Made in China © 2015 Ideavillage
customerservice@ideavillage.com
FTYMF11132015

Yes!

Quick Start Guide

Thank you for your purchase of the **Finishing Touch (FT) Yes!** Please follow these simple steps to begin eliminating unwanted hair easily and painlessly!

1. Fully charge unit prior to first use.
(It takes approximately 2.5 hours for unit to fully charge)
2. Make sure skin is clean and dry.
3. Turn switch to ON position. Purple touch activated light and green LED will flash.
4. Position Trimmer Head against the skin to begin hair removal. (Touch activated light will automatically turn on when in use.)
5. Remove hair by gliding the unit in the opposite direction of hair growth for best results.
6. For shorter hair or stubble, change to Microfoil Head.
7. Unit will turn off when not in use. Turn switch to OFF position when finished to save battery.

For complete usage please see full instructions inside



Yes!

Contained within the Package

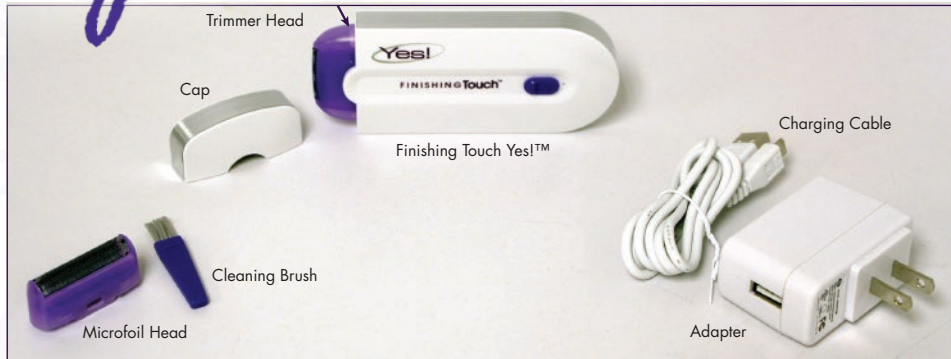

Charging the Battery

NOTE: Prior to first use, fully charge FT Yes for approximately 2.5 hours.

FT Yes must be charged with the supplied USB cable, using either the supplied AC adapter or an alternate USB source.

While the unit is charging, the red light will remain on.

The green LED will remain on when unit is connected to the adapter and fully charged. Charge will hold approximately 60 minutes run time.

Adapter and Charging Cable

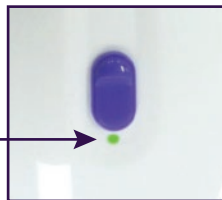
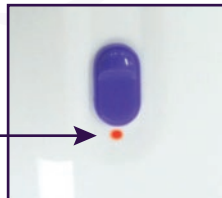

IMPORTANT SAFETY INSTRUCTIONS - SAVE THESE INSTRUCTIONS

DANGER: TO REDUCE THE RISK OF FIRE OR ELECTRIC SHOCK, CAREFULLY FOLLOW THESE INSTRUCTIONS.

FOR CONNECTION TO A SUPPLY NOT IN THE U.S.A., USE AN ATTACHMENT PLUG ADAPTER OF THE PROPER CONFIGURATION FOR THE POWER OUTLET.

Directions for Use:

Use on clean and completely dry skin with no cream or cosmetic residue.

1. Remove cover (see Image 1).
2. Move switch to ON position (toward head) (see Image 2).
3. Purple touch activated light and green LED will flash (see Image 3).
4. Position Trimmer Head against the skin to begin hair removal. (Touch activated light will automatically turn on when in use). **This unit will not begin to work until contact has been made with skin.** The purple touch activated light and the green activation LED will remain on while the unit is in use. Place the FT Yes on skin and gently glide the head of the unit along skin in the opposite direction of hair growth at a 45° angle (**NOT at a 90° angle**) (see Image 4).

DO NOT APPLY EXCESSIVE PRESSURE

DURING USE to avoid damage to skin or head of unit. Discontinue use if any skin irritation results.

5. For short hair, stubble or touch-ups, select the touch activated Microfoil Head (see Image 5). For best results while using the Microfoil Head, hold the FT Yes at a 90° angle to skin (**NOT on a 45° angle**) and apply SLIGHT pressure (see Image 6).

NOTE: For more effective hair removal, make sure to trim hair as short as possible using the Trimmer Head prior to using the Microfoil Head.

6. FT Yes will turn off within approximately 6 seconds. Green LED will return to flash. Unit will automatically turn on again when it comes in contact with skin.
7. When finished using your FT Yes, turn switch to OFF position (away from head), cover and store in cool dry place.



Image 1

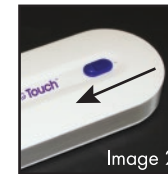

Image 2



Image 3

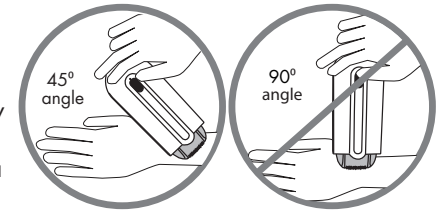

Image 4

Usage for Trimmer Head



Image 5

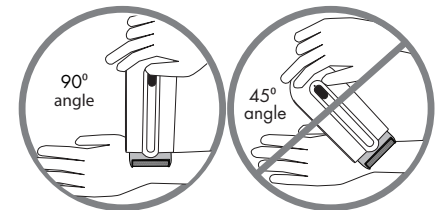

Image 6

Usage for Microfoil Head



Image 7

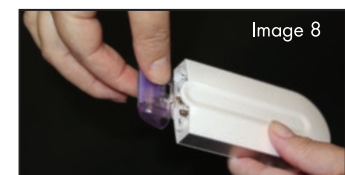

Image 8

Replacement and Microfoil Heads

To change / replace heads, place your thumbs on the back of the unit. Push gently in the direction of the arrow, toward the front and in an upward motion. The head will separate from the body. (Image 7)

Line up new head with arrow on **back** of unit and press. Head will click into position. (Image 8)