

GETTING STARTED

When you first get your Hatchimal egg out of the box, to turn it on, remove the twist locks located at the bottom of the egg. Discard the twist locks.

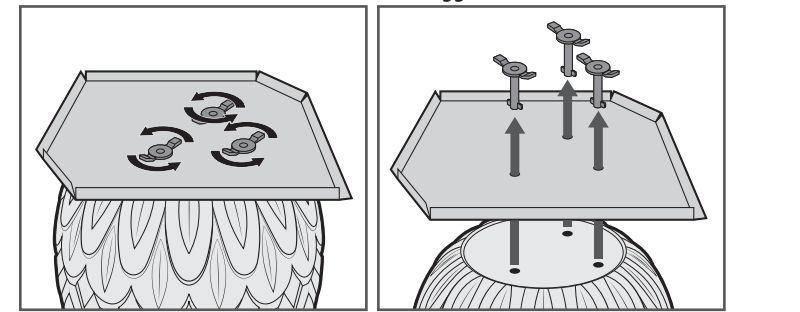

BEST PRACTICES:

- Do NOT pick me up by my neck or legs (A).
- When I am shrinking, do not place your hands around my neck, legs or base (A).
- Never push me down or pull me up (C). Just let me grow or shrink on my own.
- Hold the bottom of my egg with both hands to move my egg around (D).
- Before I hatch, do not squeeze the middle (E) or top of my egg (F), it could cause my egg to crack too early.

IN-EGG PLAY

My eye colour lets you know how to play.

<p>TAP</p> <ol style="list-style-type: none"> When I am quiet, tap on my egg, I will TAP back (flashing yellow eyes) Tap too much, I get UPSET (red eyes) Tilt and hold me still to COMFORT me (return to yellow eyes) 	<p>TILT REPEATEDLY</p> <ol style="list-style-type: none"> Tilt me backwards and right side up to PLAY with me (yellow eyes) Tilt too much, I get DIZZY (green eyes) Hold me upright to CALM ME DOWN (return to yellow eyes)
<p>TILT AND HOLD</p> <ol style="list-style-type: none"> Tilt me backwards and hold me there to CUDDLE me (pink eyes) Keep me tilted for more than 30 seconds and I will FALL ASLEEP (white eyes) 	<p>HOLD UPRIGHT</p> <ol style="list-style-type: none"> Hold me upright and I will either get COLD (blue eyes) or get the HICCUPS (orange eyes) COLD: Tilt and hold me to warm me up (return to yellow eyes) HICCUPS: Tap on the egg to scare my hiccups away (return to yellow eyes)

HATCHING TIME

- When I am ready to hatch, you will see rainbow eyes and hear the "ready to hatch" music.
- Remove the ribbon band before I begin to hatch. If you have not removed the logo ribbon, remove that first.
- If my egg is held upright, I will hatch. Note: To pause the hatch, tilt my egg backwards.
- You will hear struggling and cracking until I pop the top of my egg and say "TaDa!".
- Remove the egg top from my head and I will sing "Hatchy Birthday".
- When I'm done singing, remove me from my egg base: it is time to play!

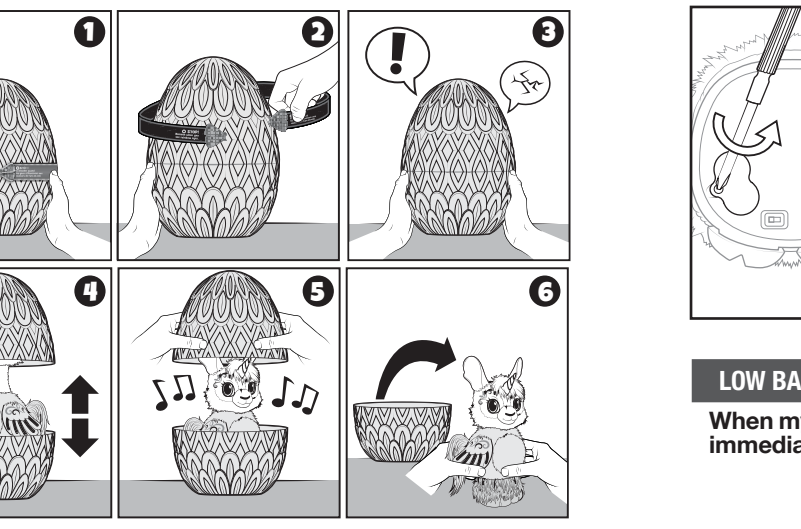

HOW TO REPLACE BATTERIES

For best results, put in new batteries after your Hatchimal hatches.

- Open the battery doors with a screwdriver.
- If used batteries are present, remove these batteries from the unit. DO NOT remove or install batteries using sharp or metal tools. Install new batteries as shown in the polarity diagram (+/-) inside the battery compartment.
- Replace both battery doors securely.
- Check your local laws and regulations for correct recycling and/or battery disposal.

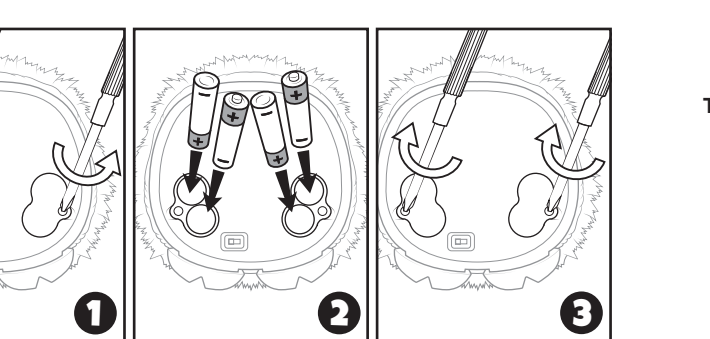

LOW BATTERIES
When my battery is running low, I fall asleep frequently and immediately after turning ON.

HATCHIMALS WOW™ LLALACORN



INTERACTION POINTS

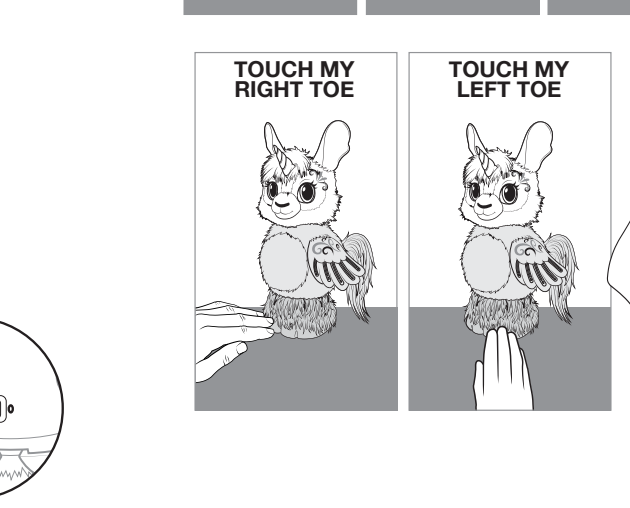
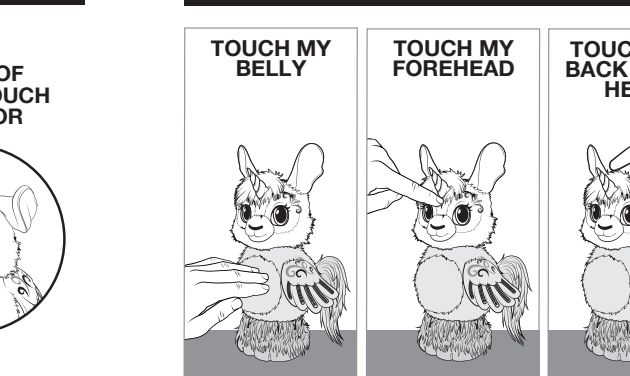

THERE ARE LOTS OF WAYS TO MAKE ME GROW TALL. TRY THESE:

1) FEED (PURPLE EYES)

- To feed me, hold my fruit against my forehead (eyes turn purple).
- Now you can make me chase the fruit. Hold it against my forehead and I will chase it upwards (A). Hold it against my belly and I will chase it downwards (B).
- Make me chase for too long and I get sad.
- Guide me all the way to the top and keep holding the fruit against my forehead. I will start to munch the fruit (C).
- If I eat enough, I return to yellow eyes.
- If I eat too much, I get gassy (orange eyes). Pat the back of my head to burp me (D) (return to yellow eyes).



2) TICKLE/HICCUPS (FLASHING YELLOW/FLASHING ORANGE)

- Quick touches to my belly equal tickles.
- Tickle me until I reach the top and I get the hiccups (orange eyes).
 - Make a loud sound with your voice for 2 seconds to scare my hiccups away (return to yellow eyes).

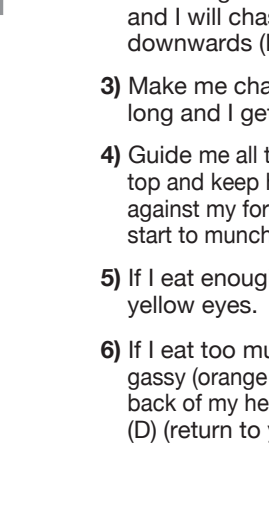

3) "PUMP IT UP"

- Touch one of my toes three times. I will start to sink down.
- Now tap one of my toes and I will start to inflate like a balloon.
- If you stop tapping, I start sinking back down.
- Reach the top to burst the balloon.

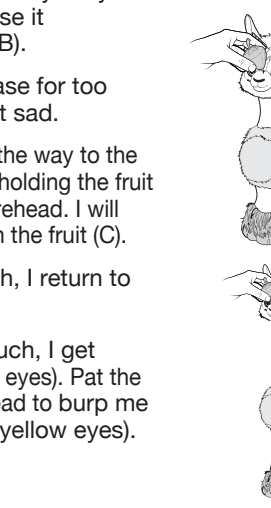

4) HYPNOTIZE (WHITE EYES)

- Hold my forehead and the back of my head at the same time to hypnotize me. My eyes will turn pink.
- Keep holding until my eyes turn white. Now you can make me move up and down.
- Hold the back of my head to move me down (B).
- If I reach the bottom I'll fall asleep!
- Touch forehead and back of head at the same time = release from Hypnotize (return to yellow eyes) (C).

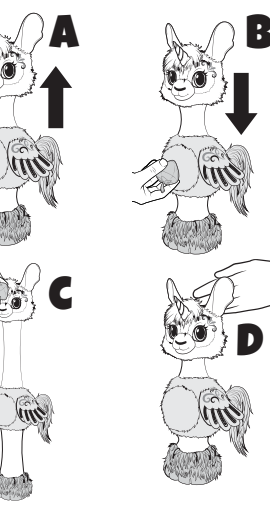

5) SCARED (BLUE EYES)

- When I am quiet, make a loud sound with your voice for 2 seconds to scare me (eyes turn blue) (A).
- Pet the back of my head to calm me down (return to yellow eyes) (B).

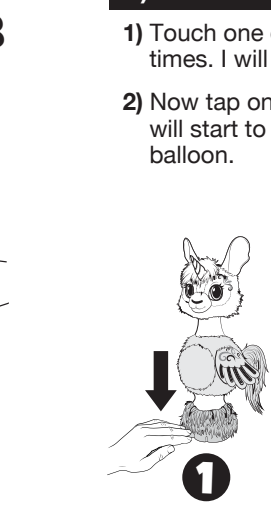

PLAY (YELLOW EYES)

- Tilt me backwards and upright to play with me (yellow eyes).
- Tilt too much and I get dizzy (green eyes).
- Put me back down so I can catch my breath (return to yellow eyes).

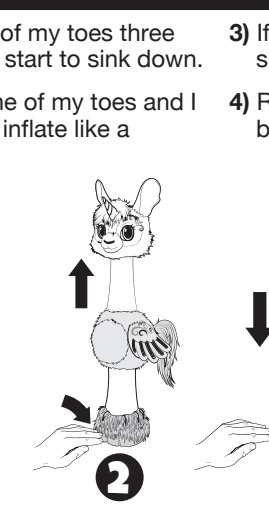

SNUGGLE (PINK EYES)

- Pick me up and tilt me back to snuggle me. I will shrink down into a cuddly size.
- Pet back of head or forehead = coos (A).
- Tickle belly = giggles (B).
- Hold the back of my head and hold me to your chest at the same time = hug (C).

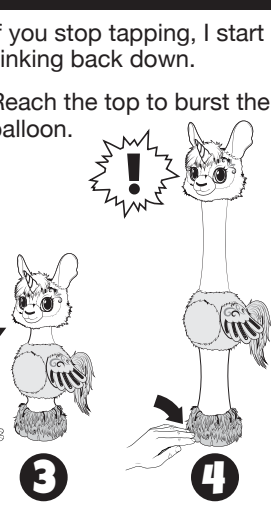

PET (PINK EYES)

- Pet the back of my head to make me coo.
- Keep petting and I might say "I love you" or blow you a kiss.

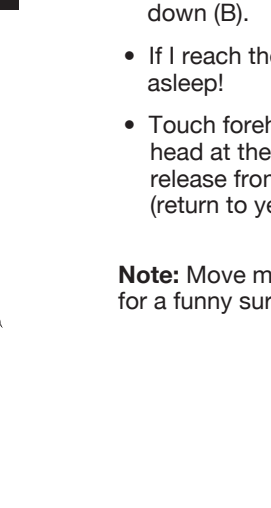

HERE WE GROW

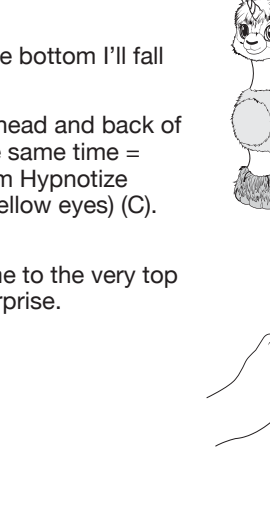
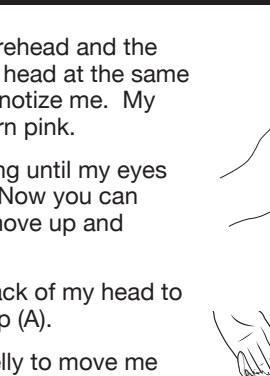

LOW BATTERIES

When my battery is running low, I fall asleep frequently and immediately after turning ON.

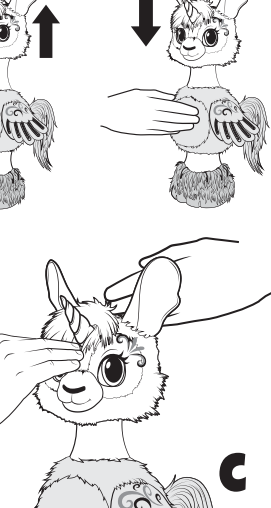

LOW BATTERIES

When my battery is running low, I fall asleep frequently and immediately after turning ON.

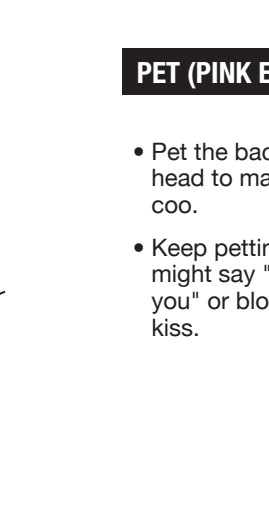

LOW BATTERIES

When my battery is running low, I fall asleep frequently and immediately after turning ON.

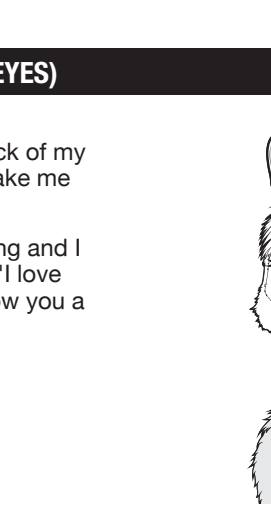

LOW BATTERIES

When my battery is running low, I fall asleep frequently and immediately after turning ON.



LOW BATTERIES

When my battery is running low, I fall asleep frequently and immediately after turning ON.

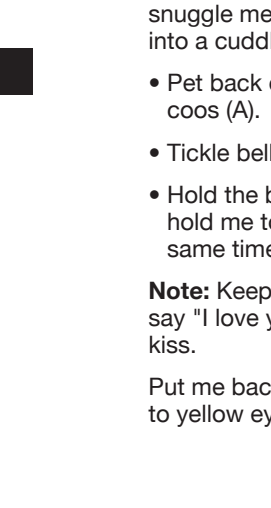

LOW BATTERIES

When my battery is running low, I fall asleep frequently and immediately after turning ON.

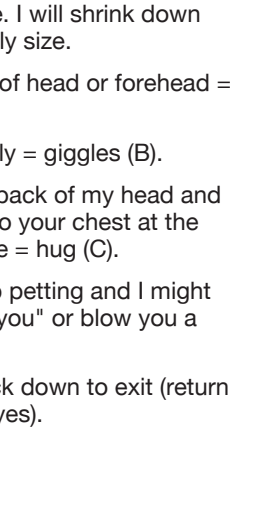

LOW BATTERIES

When my battery is running low, I fall asleep frequently and immediately after turning ON.

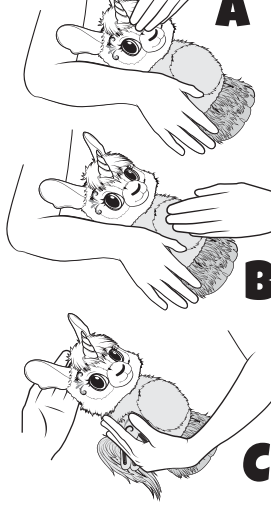

SNEEZE (ORANGE EYES)

Sometimes I will say "Ahh ahh" and start to rise up.

- Touch and hold my forehead to move me down
- Reach the bottom = sneeze goes away
- Reach the top = big sneeze

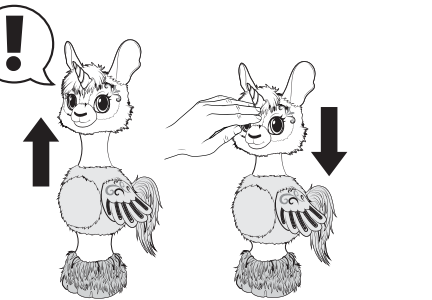

PEEK-A-BOO (YELLOW EYES)

- 1) Put the egg top on my head.
- 2) My eyes will turn off and I will make curious sounds.
- 3) Take the egg top off, my eyes will light up and I will say "Peek-a-boo!"

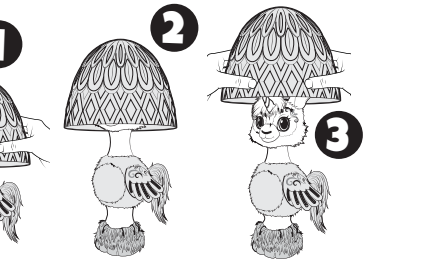

Note: For a funny surprise, try tapping one of my toes while the egg top is on my head.

SING AND DANCE (RAINBOW EYES)

Touch and hold my belly and toe for 3 seconds

- My right toe = song 1 (A)
- My left toe = song 2 (B)

While I'm singing and dancing:

- Touch forehead = sing higher (C)
- Touch a toe = sing lower (D)
- Belly = pause

To exit, touch and hold my forehead and the back of my head at the same time (E).

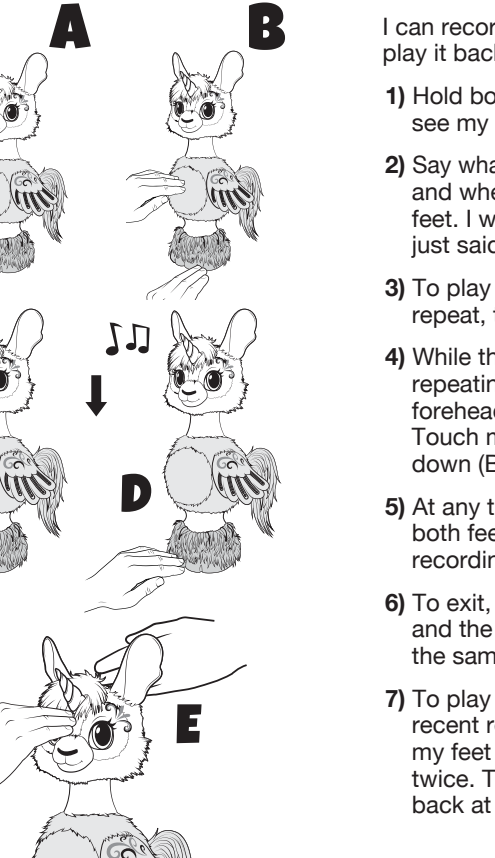

RECORD AND REPEAT (TEAL EYES)

I can record your voice and play it back at different pitches.

- 1) Hold both my feet until you see my eyes turn solid teal.
- 2) Say what you want to record, and when done, let go of my feet. I will repeat what you just said once.
- 3) To play your recording on repeat, touch one of my toes.
- 4) While the recording is repeating, touch my forehead to pitch it up (A). Touch my belly to pitch it down (B).
- 5) At any time, touch and hold both feet to start a new recording.
- 6) To exit, touch my forehead and the back of my head at the same time.
- 7) To play back your most recent recording, pat both my feet at the same time, twice. Then you can start back at step 3.

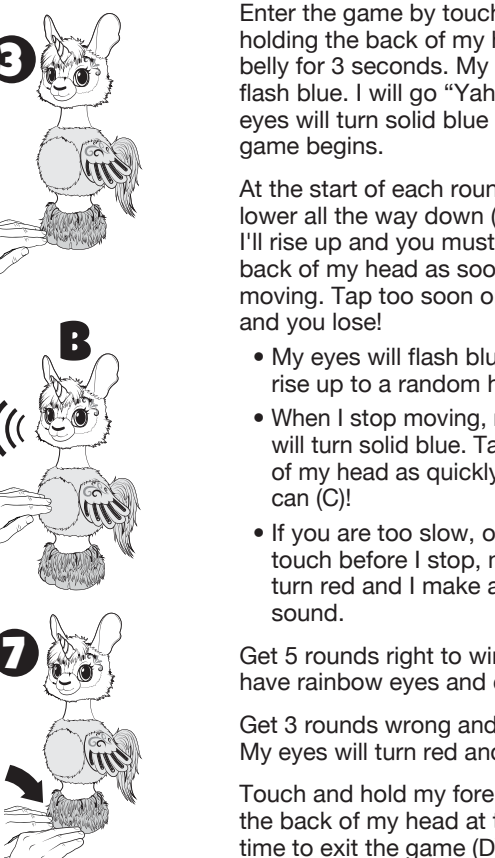

"TOP TAP"

Enter the game by touching and holding the back of my head and belly for 3 seconds. My eyes will flash blue. I will go "Yah" and my eyes will turn solid blue when the game begins.

At the start of each round I will lower all the way down (A). Then I'll rise up and you must tap the back of my head as soon as I stop moving. Tap too soon or too late and you lose!

- My eyes will flash blue while I rise up to a random height (B).
- When I stop moving, my eyes will turn solid blue. Tap the back of my head as quickly as you can (C)!
- If you are too slow, or you touch before I stop, my eyes turn red and I make a sad sound.

Get 5 rounds right to win. I will have rainbow eyes and celebrate.

Get 3 rounds wrong and you lose. My eyes will turn red and I get sad.

Touch and hold my forehead and the back of my head at the same time to exit the game (D).

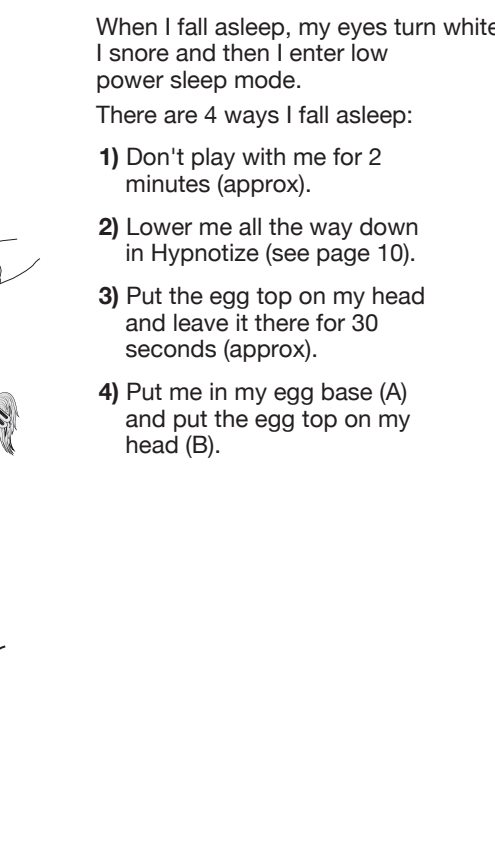

FALLING ASLEEP (WHITE EYES)

When I fall asleep, my eyes turn white, I snore and then I enter low power sleep mode.

There are 4 ways I fall asleep:

- 1) Don't play with me for 2 minutes (approx).
- 2) Lower me all the way down in Hypnotize (see page 10).
- 3) Put the egg top on my head and leave it there for 30 seconds (approx).
- 4) Put me in my egg base (A) and put the egg top on my head (B).

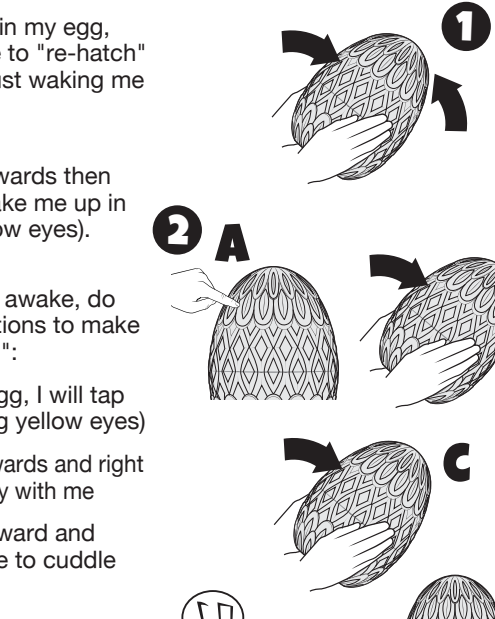

"RE-HATCHING"

When I'm back in my egg, you can choose to "re-hatch" me instead of just waking me up.

- 1) Tilt me backwards then upright to wake me up in the egg (yellow eyes).
- 2) Now that I'm awake, do three interactions to make me "re-hatch":
 - (A) tap on my egg, I will tap back (flashing yellow eyes)
 - (B) tilt me backwards and right side up to play with me
 - (C) tilt me backward and hold me there to cuddle me
- 3) When I'm ready to "re-hatch", you will see rainbow eyes and hear the "ready to hatch" music.
- 4) Hold my egg upright and I will pop the top off myself. I will be in a random wake-up mood.

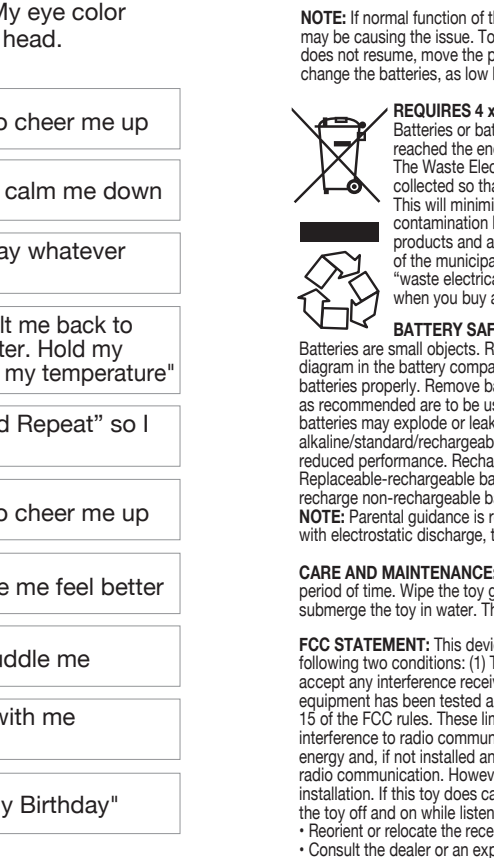

WAKE UP MOODS

You never know what mood I will wake up in. My eye color tells you my mood. Wake me up by petting my head.

RED	I am UPSET	Get me to sing to cheer me up
ORANGE	I am EXCITED	Hypnotize me to calm me down
YELLOW	I am HAPPY	I am happy to play whatever you want
GREEN	I feel SICK	Pick me up and tilt me back to make me feel better. Hold my forehead to "take my temperature"
TEAL	I am CHATTY	Play "Record and Repeat" so I can talk
BLUE	I am SAD	Tickle my belly to cheer me up
PURPLE	I am HUNGRY	Feed me to make me feel better
PINK	I am CUDDLY	Pick me up to cuddle me
WHITE	I am SLEEPY	Play "Top Tap" with me to wake me up
RAINBOW	It is my BIRTHDAY	I will sing "Hatchy Birthday"

For TROUBLESHOOTING questions and solutions, please visit our website: www.Hatchimals.com

NOTE: If normal function of the product is disturbed or interrupted, strong electromagnetic interference may be causing the issue. To reset product, turn it completely off, then turn it back on. If normal operation does not resume, move the product to another location and try again. To ensure normal performance, change the batteries, as low batteries may not allow full function.

REQUIRES 4 x 1.5V AA (LR6) ALKALINE BATTERIES (INCLUDED). Batteries or battery packs must be recycled or disposed of properly. When this product has reached the end of its useful life, it should not be disposed of with other household waste. The Waste Electrical and Electronic Equipment Regulations require it to be separately collected so that it can be treated using the best available recovery and recycling techniques. This will minimize the impact on the environment and human health from soil and water contamination by any hazardous substances, decrease the resources required to make new products and avoid using up landfill space. Please do your part by keeping this product out of the municipal waste stream! The "wheeler bin" symbol means that it should be collected as "waste electrical and electronic equipment". You can return an old product to your retailer when you buy a similar new one. For other options, please contact your local council.

BATTERY SAFETY INFORMATION: Batteries are small objects. Replacement of batteries must be done by adults. Follow the polarity (+/-) diagram in the battery compartment. Promptly remove dead batteries from the toy. Dispose of used batteries properly. Remove batteries for prolonged storage. Only batteries of the same or equivalent type as recommended are to be used. DO NOT incinerate used batteries. DO NOT dispose of batteries in fire, as batteries may explode or leak. DO NOT mix old and new batteries or types of batteries (i.e. alkaline/standard/rechargeable). Using rechargeable batteries is not recommended due to possible reduced performance. Rechargeable batteries are only to be charged under adult supervision. Replaceable-rechargeable batteries are to be removed from the toy before being charged. DO NOT recharge non-rechargeable batteries. DO NOT short-circuit the supply terminals.

NOTE: Parental guidance is recommended when installing or replacing batteries. Under the environment with electrostatic discharge, the toy may malfunction and require user to reset the toy.

CARE AND MAINTENANCE: Always remove batteries from the toy when it is not being used for a long period of time. Wipe the toy gently with a clean damp cloth. Keep the toy away from direct heat. Do not submerge the toy in water. This can damage the electronic assemblies.

FCC STATEMENT: This device complies with Part 15 of the FCC rules. Operation is subject to the following two conditions: (1) This device may not cause harmful interference, and (2) This device must accept any interference received, including interference that may cause undesired operation. This equipment has been tested and found to comply with the limits for Class B digital devices pursuant to Part 15 of the FCC rules. These limits are designed to provide reasonable protection against harmful interference to radio communications. This equipment generates, uses and can radiate radio frequency energy and, if not installed and used in accordance with the instruction, may cause harmful interference to radio communication. However, there is no guarantee that interference will not occur in a particular installation. If this toy does cause interference to radio or television reception (you can check this by turning the toy off and on while listening for the interference), one or more of the following measures may be useful: • Reorient or relocate the receiving antenna • Increase the separation between the toy and the radio or the TV • Consult the dealer or an experienced TV-radio technician for help.

NOTE: Changes, adjustments or modifications to this unit, including but not limited to, replacement of any transmitter component (crystal, semiconductor, etc) could result in a violation of FCC rules under part 15 and/or 95 and must be expressly approved by Spin Master Ltd or they could void the user's authority to operate the equipment. Spin Master Inc., PMB #10053, 300 International Drive, Suite 100, Williamsville, NY 14221. To contact the responsible party please visit fcc.spinmaster.com

CAN ICES-3(B)/NMB-3(B)

Do not change or modify anything on the toy.
BEFORE FIRST USE: Read the user's information together with your child.

TM & © Spin Master Ltd. All rights reserved. Retain this information, addresses and phone numbers for future reference. Keep away from obstacles and electrical hazards. Spin Master Ltd. reserves the right to discontinue the www.Hatchimals.com website at any time.

SPIN MASTER LTD.
225 KING STREET WEST,
TORONTO, ON
M5V 3M2 CANADA

Imported into EU by
SPIN MASTER INTERNATIONAL, B.V.,
Kingsfordweg 151, 1043 GR Amsterdam, The
Netherlands
www.spinmaster.com

Imported by
Spin Master Australia
Pty Ltd, Suite 101, Level 1,
16-24 Chandos Street,
St Leonards, NSW 2065;
1800 316 982

MADE IN CHINA



T19154_0001_20108325_GBL_IS_R2_EN



5+ years



Easy to follow instruction videos:
HATCHIMALS.COM

CONTENTS: 1 Hatchimals WOW™, 1 Re-Hatchable Egg, 1 Accessory, Instruction Booklet

NORTH AMERICA
1-800-622-8339, customercare@spinmaster.com
MEXICO - 01 800 9530147, servicio@spinmaster.com
UK - 0800 206 1191, serviceuk@spinmaster.com
IRELAND - 1800 992 249
FRANCE - 0800 909 150, servicefr@spinmaster.com
AUSTRALIA - 1800 316 982, customercare@spinmaster.com