

FX6

**GROUP INTERCOM HELMET
BLUETOOTH HEADSET**

Table of Content

1 Packing List	1
2 Function Introduction	1
3 Installation Step	2
3.1 Fixed by clamp	2
3.2 Fixed by VELCRO sticker	4
4 Disassembly of device	4
5 Product Introduction	5
6 Button Operation Introduction	6
6.1 ON/OFF Button	6
6.2 Mutil-funtion Button	7
6.3 Konb	8
7 Bluetooth Status Indication and Prompt	8
8 Paring Methods	9
8.1 Two ways for FX6 to enter paired state	9
8.2 Pairing with any bluetooth headset	9
8.3 Pairing with Mobile Phone,GPS and MP3	10
8.4 Pairing between two FX6	10
8.5 Group Intercom Settings	11
8.6 Simultaneous connection of multiple devices	12
9 Priority of Function	13
10 Specification	13
11 Matters Needing Attention	14

1.Packing List



Bluetooth
Device

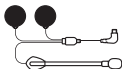

Microphone &
Ear Speakers



Clamp



Velcro Clamp



Manual



Headphone
Velcro



USB Cable



Screw Driver

2.Function Introduction



Fleet communication



Connect to any
bluetooth headset



Simultaneous connection
of multiple devices



Operating range
1000 meters



Connected with
2 mobile phones



Stereo music
A2DP



Voice Dial



Voice prompt



Usable during
recharging



Bluetooth 5.0



FM Radio



Connected with
two-way radio



Playback
Control



Water-proof



Advanced
noise control

3. Installation Step

3.1 Fixed by clamp

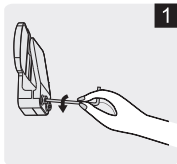

1. Loosen the screws
on the back of clamp
with the provided
screw driver.



2. Open the lining of
helmet, insert the
clamp in the proper
position on the left of
helmet and fasten the
screw.

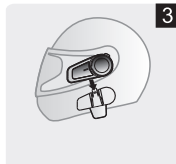

3. Slide the back track
of the device into the
clamping track.



4. Open the inner lining on the ear position of the helmet and attach the VELCRO loop.

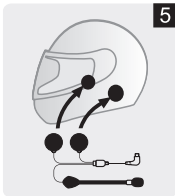

5. Attach the Headphone Velcro hook to the loop (the short-line speaker is on the left).

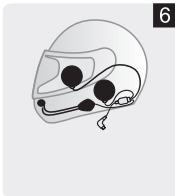

6. Place butterfly sticker in the right position on the left side of the helmet, match the microphone with the mouth position, and tidy up the line and lining.

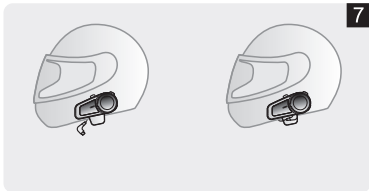

7. Insert the plug into the headset socket and the installation complete.

3.2 Fixed by VELCRO sticker

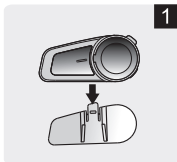

1. Slide the back track of the device into the clamping track.

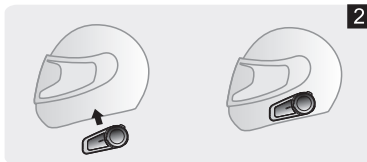

2. Tear off the white paper on the back of the clamp and stick it in the right position on the left side of the helmet.

3. Ear speakers & Microphone installation step refer to 3.1

4. Disassembly of the Device

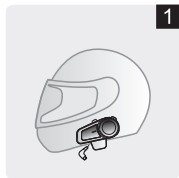

1. Pull out the headset plug.

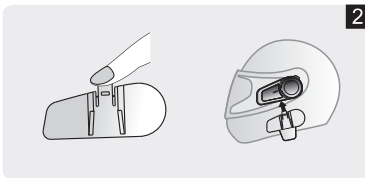

2. Press the upper clamp buckle and move the device upward to remove it.

5. Product Introduction

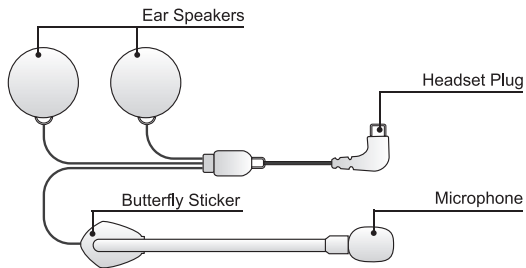
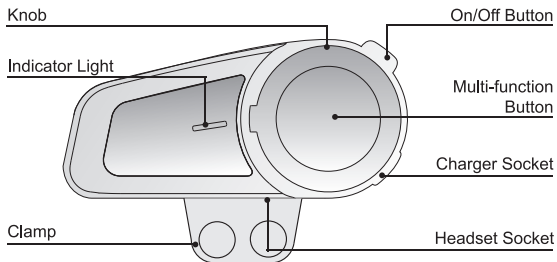

6. Button Operation Introduction

6.1 On/Off Button

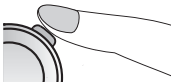

- **Turn on** (When the headset is off, press and hold it for 3 seconds. There is a “Welcome to FODSPORTS Bluetooth Communication System” sound prompt, and the blue light will be on for 1 second.)
- **Turn off** (When the headset is on, press and hold it for 5 seconds. There is a “Power Off” sound prompt, and the red light will be on for 1 second.)
- **Pairing** (When the headset is off, press and hold it for 6 seconds. There is a “Pairing” sound prompt, and blue and red lights flash alternately.)
- **Clear the pairing device** (When the headset is on, press down the button and hold the button down for another 3 seconds after hearing “power off” sound prompt until the red light quickly flashes 3 times and a “toot” sound prompt can be heard.)
- **Start the Bluetooth Intercom** (When paired, press once on the button, you will hear an "Intercom Connected" sound prompt When the connection is successful, then press again to disconnect the intercom, then press again to reconnect
- **Note:** When B connects with A first and then connected with C, B needs to press the button twice to initiate intercom with A, and B needs to press the button once to initiate intercom with C
- **End the Bluetooth Intercom** (Shortly press the button and intercom closes after a “Intercom disconnected” sound prompt.)

6.2 Multi-function Button

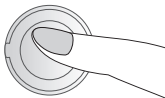

- **Pairing** (When the headset is on, press and hold it for 6 seconds. There is a “Pairing” sound prompt, and blue and red lights flash alternately.)
 - **Answering a call** (When connected and there is a call, click it once or take no action in 10 seconds. The call will be put through automatically with a “Dong, Dong” sound prompt.)
 - **Rejection of call** (If there is a call, press and hold it for 2 seconds. The call will be rejected with a “Dong, Dong” sound prompt.)
 - **Voice switching between Bluetooth headset and mobile phone itself** (During a call, press and hold it for 2 seconds. There is a “Dong” sound prompt, and the red light flash every other second.)
 - **End a call** (During the call, click it once and there is a “Dong” sound prompt.)
 - **Voice dialing** (If you are not on a call, click it twice and there is a “Voice Dial” sound prompt.)
 - **Music Play/Pause** (When connected, click it once.)
 - **Switch between bluetooth and FM** (When the headset is on, triple-click it and there is “Bluetooth mode” or “FM mode” sound prompt.)
- *Turn on/off FM: When device is on, short press Multi-function Button 3 times to Switch on / off FM function.**

6.3 Knob

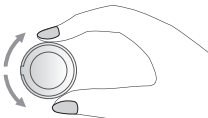

- **Turn up the volume** (On a call , intercom, playing music or FM, turn the knob clockwise and hold it to increase volume until it reaches the level you want . A “toot” prompt will be heard when it reaches Max volume.)
- **Turn down the volume** (On a call , intercom, playing music or FM, turn the knob counter clockwise and hold it to decrease volume until it reaches the level you want . A “toot” prompt will be heard when it reaches Min volume.)
- **Play the next** (When playing music or FM, turn the knob clockwise .)
- **Play the previous** (When playing music or FM, turn the knob counter clockwise .)

7. Bluetooth Status Indication and Prompt

- **Power on status** (If Bluetooth is connected, there is a “Bluetooth connected” sound prompt ,the blue indicator light flashes once every 6 seconds; if Bluetooth is not connected, there is a “Bluetooth disconnected” sound prompt , the blue indicator light flashes twice every 6 seconds.)
- **Low power alarm** (The “Battery Low” sound is prompted every 60 seconds when the power is turned on, and the indicator light turns to red light flashing.)
- **Charging state** (Red light is on when charging. Red light is off when charging is completed.)

Battery status sound prompt when powered on (If the battery is full, the “Battery Full” sound is prompted. If the battery is low, the “Battery Low” sound is prompted.)

8. Pairing Methods

8.1 Two ways for FX6 to enter paired state

8.1.1 Mode 1: When the headset is off, press and hold On/Off Button for 6 seconds. There is a “Pairing” sound prompt, and blue and red lights flash alternately.

8.1.2 Mode 2: When the headset is on, press and hold Multi-function Button for 6 seconds. There is a “Pairing” sound prompt, and blue and red lights flash alternately.

8.2 Pairing with the Non-Fodsports FX6 intercom function Bluetooth device



Step 1: Place the FX6 and the device within a visible range of 1 meter.

Step 2: Set the Non-FX6 intercom function Bluetooth device into pairing mobile phone status.

Step 3: Follow step (8.1.2), FX6 enters pairing status.

Step 4: Short press FX6 on/off button, then it will search for the device for pairing, the “intercom connected” sound prompt means the connection is successful.

Note 1: In step 4, the intercom connection must be initiated by FX6.

Note 2: When intercom, press FX6 on/off button to disconnect the intercom, then press again to reconnect.

8.3 Pairing with Mobile, GPS and MP3

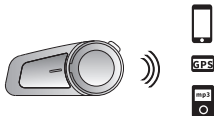

Step 1 : Place the "FODSPORTS FX6" and the device within a visible range of 1 meter.

Step 2 : Follow step (8.1.1), "FODSPORTS FX6" enters pairing status

Step 3 : Turn on the device Bluetooth, search "FODSPORTS FX6" and connect. The "connected" sound prompt means the connection is successful.

8.4 Pairing between two FX6



Step 1 : Ensure both FX6 are off and within 1 meter visible range with each other.

Step 2 : Follow step (8.1.1), both FX6 are paired.

Step 3 : Short press the multi-function button or on/ off button on either FX6, then it will search for the other FX6 for pairing, the "intercom connected" sound prompt means the connection is successful. (**NOTE: In the pairing status, short press multi-function button on either FX6 to search, can be used for connection between FX6 only. For other non-FX6 device, you have to press the on/ off button.**)

8.5 Group Intercom Settings

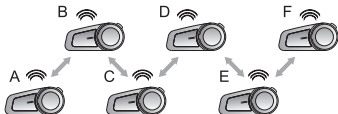

Note: A and F are not allowed to be paired.

Step 1 : Clear the matching record between A and F

Press and hold the on/off buttons of A and F for 6 seconds until you hear sound prompt “power off ”, then hold them for another 3 seconds.

Step 2 : Refer to the matching operations in 8.4 for following operations

1. Match A and B, and turn of B after match is completed;
2. Match B and C, and turn of C after match is completed;
3. Match C and D, and turn of D after match is completed;
4. Match D and E, and turn of E after match is completed;
5. Match E and F.

Step 3 : Connect A, B, C, D, E and F in series

1. For D, press the on/off button to connect with E;
 2. For C, press the on/off button to connect with D;
 3. For B, press the on/off button to connect with C;
 4. For A, press the on/off button to connect with B;
- E and F are not disconnected after the step 2 is completed.

Now A, B, C, D, E and F are all matched successfully, you can enter group intercom.

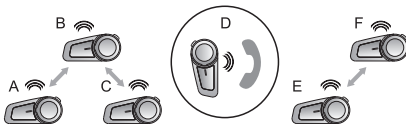

Note: During the 6 people group intercom, if D receives a call, D will be disconnected temporarily from the group. A, B and C form a group, E and F form a group. After D's call is over, D will be automatically reconnected into the group intercom and 6 people group intercom resumes.

8.6 Simultaneous connection of multiple devices

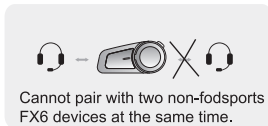
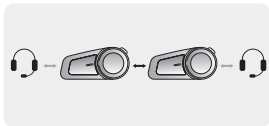
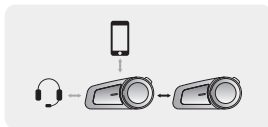
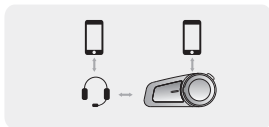

Cannot pair with two non-fodsports FX6 devices at the same time.

Note: When non-fodsports device is connected to the mobile phone first and then looped into FX6 multi-person intercom, it may cause intercom communication error. If not connected to mobile phone, no this error.

9. Priority of Functions

Level 1: Phone call & Intercom by introduced adapter.

Level 2: Intercom introduced by Two-way radio cable.

Level 3: Bluetooth Intercom

Level 4: FM & Music

10. Specifications

Bluetooth Version	5.0
Operating Range	Up to 1000 meters
Standby Time	Up to 200 hours
Operating Time	Up to 10 hours
Charging Time	Approximately 2.5 hours
Charging Interface	Micro USB Android universal plug
Battery Type	Rechargeable Li-Polymer Batteries
Power Supply	5V – 0.5A
Operating Temperature	14F-131F (-10°C-55°C)
Storage Temperature	-4F-140F (-20°C~60°C)

* Depending on the phone type and usage, the actual time may vary.

* The working distance will be deviated due to the influence of environment and climate

11. Matters Needing Attention

1.The Bluetooth name is "FODSPORTS FX6".



2.The appropriate storage temperature for this device is between -20 ℃ and 60 ℃.

Please do not store it in environment with too high or too low temperatures. Otherwise the service life will be affected.

3.Please do not expose it to open fire, to avoid explosion.

4.For a long period of time without being used, please keep the device in dry place and charge it regularly (once every 3 months), to ensure it work properly.

FODSPORTS



fodsportsclub.com

CE FC

RoHS
COMPLIANT



MADE IN CHINA